

- A** = Lagerung Kundenwelle Bearings for customer shaft
- K** = Kundenseitige Anschlussmasse Required mating dimensions
- M** = Meßpunkt Arbeitstemperatur Operating temperature measuring point
- H1** = Stiftleiste 14-pol. 14-pin connector
- H2** = Gußdeckel Die-cast cover
- H3** = Selbstsichernde Schraube M5 x 50
DIN 6912 - SW 4
Anzugsmoment 5 +0.5 Nm Self-locking-screw M5 x 50
DIN 6912 - SW4
torque 5 +0,5 Nm
- H4** = ERN Referenzmarkenlage
Welle - Kappe ERN reference mark position
shaft - housing
- H5** = Verschlusschraube SW 3 und 4
Anzugsmoment 5 +0.5 Nm Locking screw SW 3 and 4
Anzugsmoment 5 +0,5 Nm
- H6** = Befestigung für Kabel mit Crimp-Hülse
φ 6 +0,3 x 10 Mounting for cable with crimp barrel of
φ 6 +0,3 x 10
- H7** = Abdrückgewinde M10 back-off thread M10
- H8** = Abdrückgewinde M6 back-off thread M6
- H9** = Ausgleich von Montagetoleranzen und thermischer
Ausdehnung, keine dynamische Bewegung Compensation of mounting tolerances and
thermal expansion, no dynamic motion

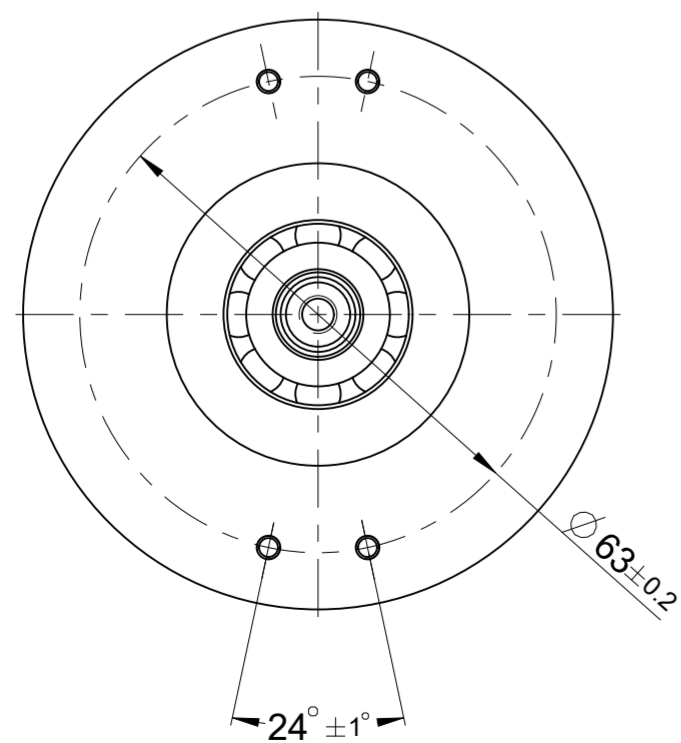

K

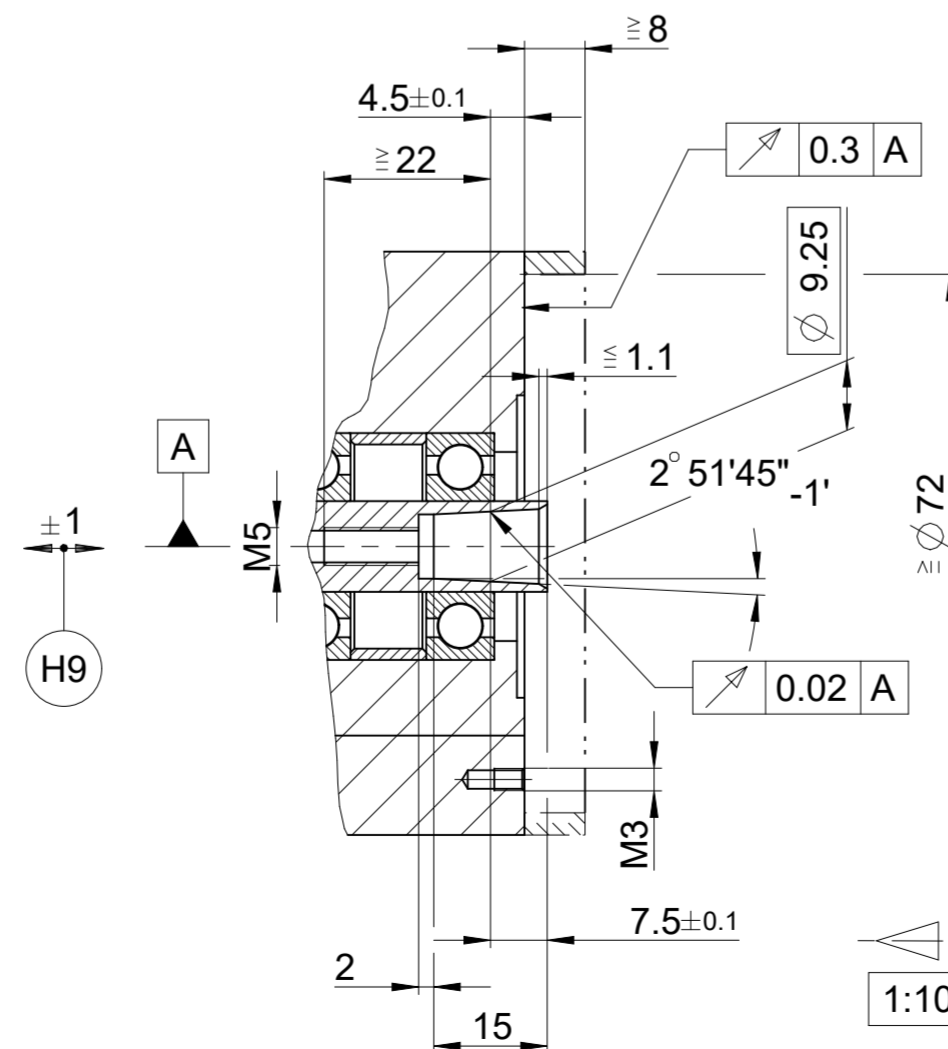

65B 14
WELLA1 KUPPA1

Original drawing		ERN 1387		ID number:	
Scale	Format	ERN 1387		Change No. C151346-05	
Dimensions in mm	1:1 A2	Anschlussmaße / Mating Dimensions		Phase: Serie	
The reproduction, distribution and utilization of this document as well as the communication of its contents to others without express authorization is prohibited. Offenders will be held liable for the payment of damages. All rights reserved in the event of the grant of a patent, utility model or design. (ISO 16016)				Tolerances as per ISO 8015	
General Tolerances ISO 2768:1989-mH ±0.2				Released	
HEIDENHAIN DR. JOHANNES HEIDENHAIN GmbH 83301 Traunreut, Germany				Version Revision Sheet Page	
30.10.2023				D 556185-02 - A-01	
Document number				1 of 1	