

$U_p = 5 V \pm 10 \%$   
(max. 150 mA)

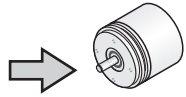

EN 50 178/4.98; 5.2.9.5  
IEC 364-4-41: 1992; 411(PELV/SELV)  
(siehe, see, voir, vedi, véase  
HEIDENHAIN D 231 929)

$\overline{U_{aS}}$ : Störungssignal  
*Fault detection signal*  
Signal de perturbation  
Segnale di malfunzionamento  
Señal de avería

$\overline{U_{aS}}$  = High:

$\overline{U_{aS}}$  = Low:

TTL

$U_{a1}, U_{a2}, U_{a0}$   
 $\overline{U_{a1}}, \overline{U_{a2}}, \overline{U_{a0}}, \overline{U_{aS}}$

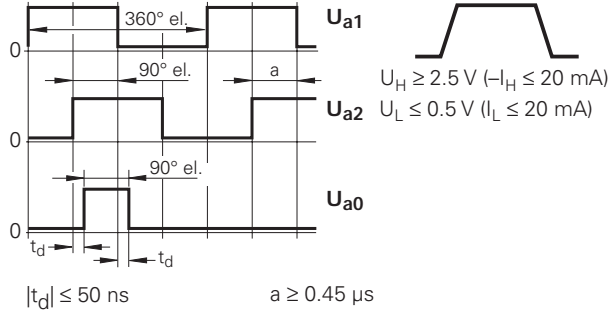

# ROD 1020 ROD 1120

## Montageanleitung Mounting Instructions Instructions de montage Istruzioni di montaggio Instrucciones de montaje

7/2003

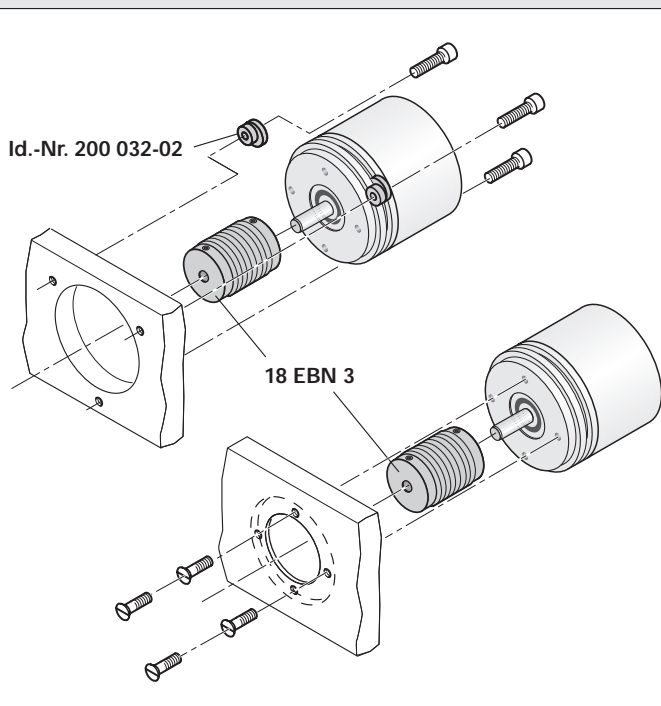
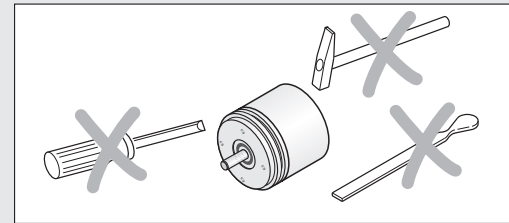
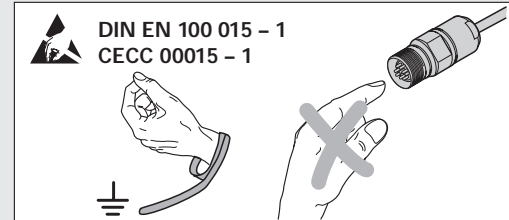
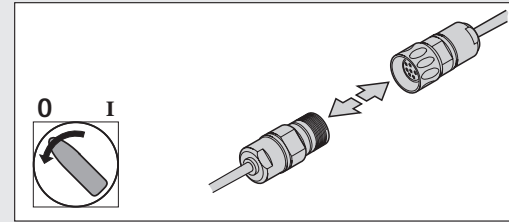

**18 EBN 3**  
Id.-Nr. 200 393-02

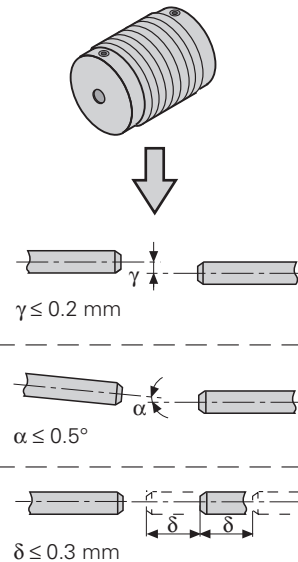

**DR. JOHANNES HEIDENHAIN GmbH**  
Dr.-Johannes-Heidenhain-Straße 5  
**83301 Traunreut, Germany**  
 +49/8669/31-0  
 +49/8669/5061  
e-mail: info@heidenhain.de

**Technical support** +49/8669/31-1000  
**Measuring systems** +49/8669/31-3104  
e-mail: service.ms-support@heidenhain.de  
**TNC support** +49/8669/31-3101  
e-mail: service.nc-support@heidenhain.de  
**NC programming** +49/8669/31-3103  
e-mail: service.nc-pgm@heidenhain.de  
**PLC programming** +49/8669/31-3102  
e-mail: service.plc@heidenhain.de  
**Lathe controls** +49/711952803-0  
e-mail: service.hsf@heidenhain.de

www.heidenhain.de



# ROD 1020

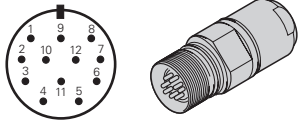

5	6	8	1	3	4	12	2	10	11	7	/
$U_{a1}$	$\overline{U}_{a1}$	$U_{a2}$	$\overline{U}_{a2}$	$U_{a0}$	$\overline{U}_{a0}$	5V $U_p$	5V sensor	0V $U_N$	0V sensor	$\overline{U}_{aS}$	/
braun brown brun marrone marrón	grün green vert verde verde	grau gray gris grigio gris	rosa pink rose rouge rosa rosa	rot red rouge rosso rojo	schwarz black noir nero negro	braun/grün brown/green brun/vert marrone/verde marrón/verde	blau blue bleu azzurro azul	weiß/grün white/green blanc/vert bianco/verde blanco/verde	weiß white blanc bianco blanco	violett violet violet viola violeta	gelb yellow jaune giallo amarillo

Die Sensorleitung ist intern mit der Versorgungsleitung verbunden.  
*The sensor line is connected internally with the power supply.*  
 La ligne de palpeur est reliée de manière interne à la ligne d'alimentation.  
*La linea del sensore è collegata internamente con la linea di alimentazione.*  
 La línea de sensor está unida internamente con la línea de alimentación.

Schirm auf Gehäuse  
*Shield on housing*  
 Blindage sur boîtier  
*Schermo sulla carcassa*  
 Blindaje a carcasa

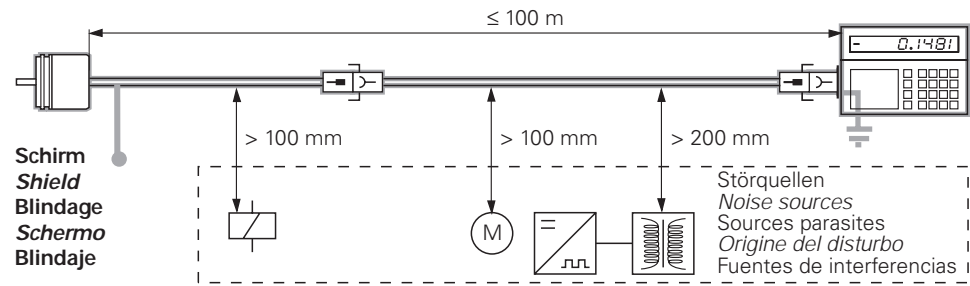

			<b>ROD 1020</b> <b>ROD 1120</b> max. <b>5 N</b> ( $\leq 10\,000\text{ min}^{-1}$ )
$T \geq -40\text{ °C}$ (-40 °F)	$T \geq -10\text{ °C}$ (14 °F)		
$\varnothing 4.5\text{ mm}$	$R_1 \geq 10\text{ mm}$	$R_2 \geq 50\text{ mm}$	<b>ROD 1020</b> <b>ROD 1120</b> max. <b>10 N</b> ( $\leq 10\,000\text{ min}^{-1}$ )
$\varnothing 8\text{ mm}$	$R_1 \geq 40\text{ mm}$	$R_2 \geq 100\text{ mm}$	

# ROD 1120

Id.-Nr. 324 276-xx

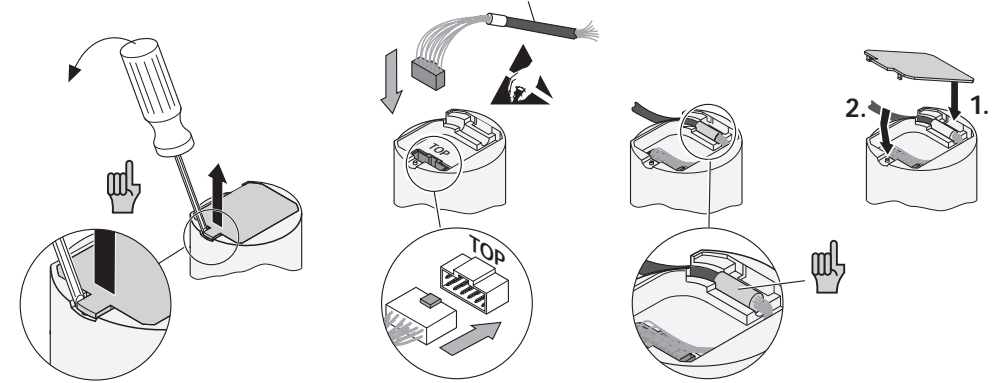

TOP	1 a	2 a	3 a	4 a	5 a	6 a	1 b	2 b	3 b	4 b	5 b	6 b
	0V $U_N$	5V $U_p$	$\overline{U}_{aS}$	$\overline{U}_{a0}$	$\overline{U}_{a2}$	$\overline{U}_{a1}$	0V sensor	5V sensor	/	$U_{a0}$	$U_{a2}$	$U_{a1}$

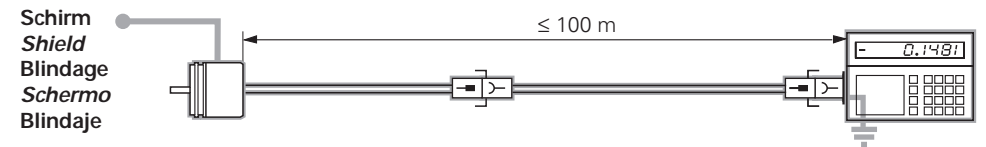

Platinenseitige Justagemöglichkeit  
*Adjustable on PCB side*  
 Possibilité de réglage côté platine  
*Possibilità di regolazione lato scheda*  
 Posibilidad de ajuste desde el lado de la pletina

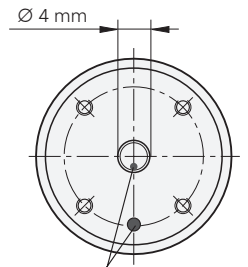

Referenzmarken-Lage  $\pm 20^\circ$   
*Reference mark position  $\pm 20^\circ$*   
 Marque de référence  $\pm 20^\circ$   
*Indici di riferimento  $\pm 20^\circ$*   
 Marca de referencia  $\pm 20^\circ$



Id.-Nr. 341 612-01

