

ROD 1050

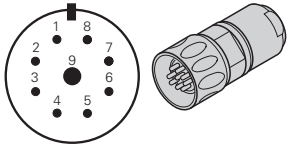
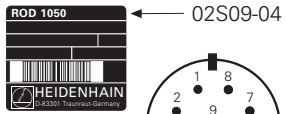

Außenschirm auf Gehäuse
External shield on housing
 Blindage externe sur boîtier
Schermo esterna sulla carcassa
 Blindaje externo a carcasa

1) Innenschirm Pin 9
Internal shield pin 9
 Blindage interne sur pin 9
Schermo interno pin 9
 Blindaje interno pin 9

| 1 | 2 | 5 | 6 | 7 | 8 | 3 | 4 | 9 |
|---|---|---|--|--|--|---|--|--|
| I_1 | | I_2 | | I_0 | | $5V U_p$ | $0V U_N$ | 1) |
| + | - | + | - | + | - | | | |
| grün <i>green</i> vert <i>verde</i> verde | gelb <i>yellow</i> jaune <i>giallo</i> amarillo | blau <i>blue</i> bleu <i>azzurro</i> azul | rot <i>red</i> rouge <i>rosso</i> rojo | grau <i>gray</i> gris <i>grigio</i> gris | rosa <i>pink</i> rose <i>rosa</i> rosa | braun <i>brown</i> brun <i>marrone</i> marrón | weiß <i>white</i> blanc <i>bianco</i> blanco | weiß/braun <i>white/brown</i> blanc/brun <i>bianco/marrone</i> blanco/marrón |

ROD 1150

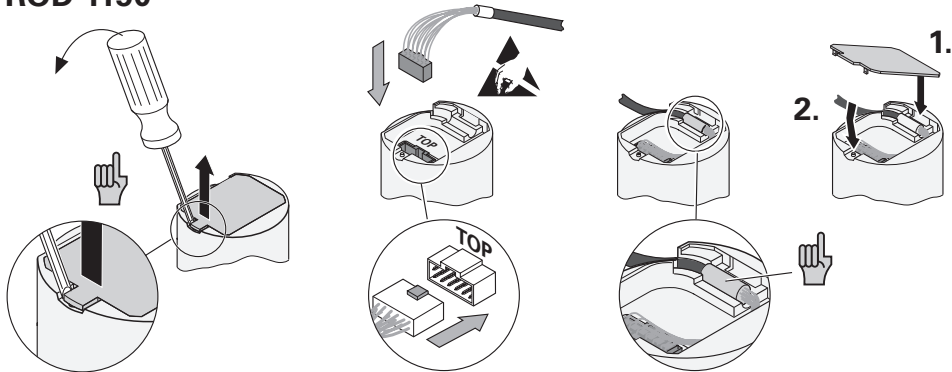

| TOP | 1 a | 2 a | 3 a | 4 a | 5 a | 6 a | 1 b | 2 b | 3 b | 4 b | 5 b | 6 b |
|-------------|----------|----------|-----|--------|--------|--------|-----|-----|-----|--------|--------|--------|
| 1 2 3 4 5 6 | $0V U_N$ | $5V U_p$ | / | I_0- | I_2- | I_1- | / | / | / | I_0+ | I_2+ | I_1+ |

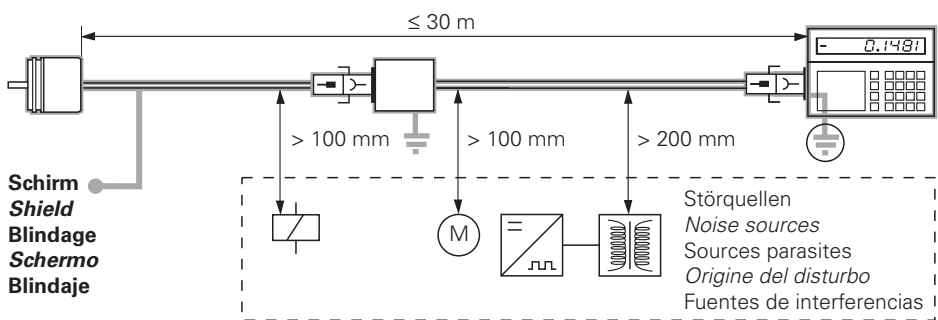

$U_p = 5V \pm 5\%$
 (I max. 85 mA)

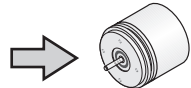

EN 50 178/4.98; 5.2.9.5
 IEC 364-4-41: 1992; 411 (PELV/SELV)
 (siehe, see, voir, vedi, véase
 HEIDENHAIN D 231 929)

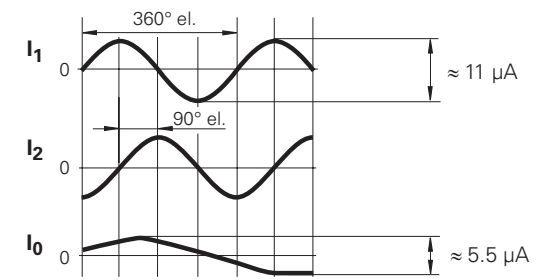
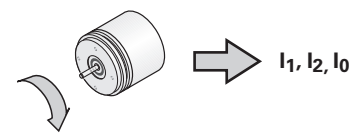

| | | |
|------------------------------|----------------------------------|---------------------------------|
| | $T \geq -40^\circ C$ (-40 °F) | $T \geq -10^\circ C$ (14 °F) |
| $\varnothing 4.5 \text{ mm}$ | $R_1 \geq 10 \text{ mm}$ | $R_2 \geq 50 \text{ mm}$ |
| | $R_1 \geq 40 \text{ mm}$ | $R_2 \geq 100 \text{ mm}$ |

| | |
|--|---|
| | max. 5 N ≤ 10 000 min ⁻¹) |
| | max. 10 N ≤ 10 000 min ⁻¹) |

°C
(°F)

-30 ... 80 °C
 (-22 ... 176 °F)