

Generation	ECN / EQN	2048 Striche / Lines	L
Generation 3.2	ECN / EQN	2048 Striche / Lines	47,2±0,5
Generation 3.1	ECN / EQN	2048 Striche / Lines	47,7±0,5

- A = Lagerung Kundenwelle Bearing for customer shaft
- K = Kundenseitige Anschlußmaße Required mating dimensions
- M = Messpunkt Arbeitstemperatur Operating temperature measuring point
- H1 = Klemmschraube mit Innensechsrund X8 Anzugsmoment 1,1 ±0,1 Nm locking screw with hexalobular recesses X8 torque 1,1 ±0,1 Nm
- H2 = Ausführung Klemmring auf Kappenseite (Lieferzustand) Model with clamping ring on cap side (Condition upon delivery)
- H3 = Ausführung Klemmring auf Kupplungsseite (wahlweise montierbar) Model with clamping ring on coupling side (Selectable mounting positions)
- H4 = Ausführung Kupplungsbefestigung an Kappe Model for attaching the coupling on housing
- H5 = Lochbild für Kupplungsbefestigung siehe Geber See the encoder for the hole pattern for attaching the coupling
- H6 = Ausgleich von Montagetoleranzen und thermischer Ausdehnung, keine dynamische Bewegung Compensation of mounting tolerances and thermal expansion, no dynamic motion

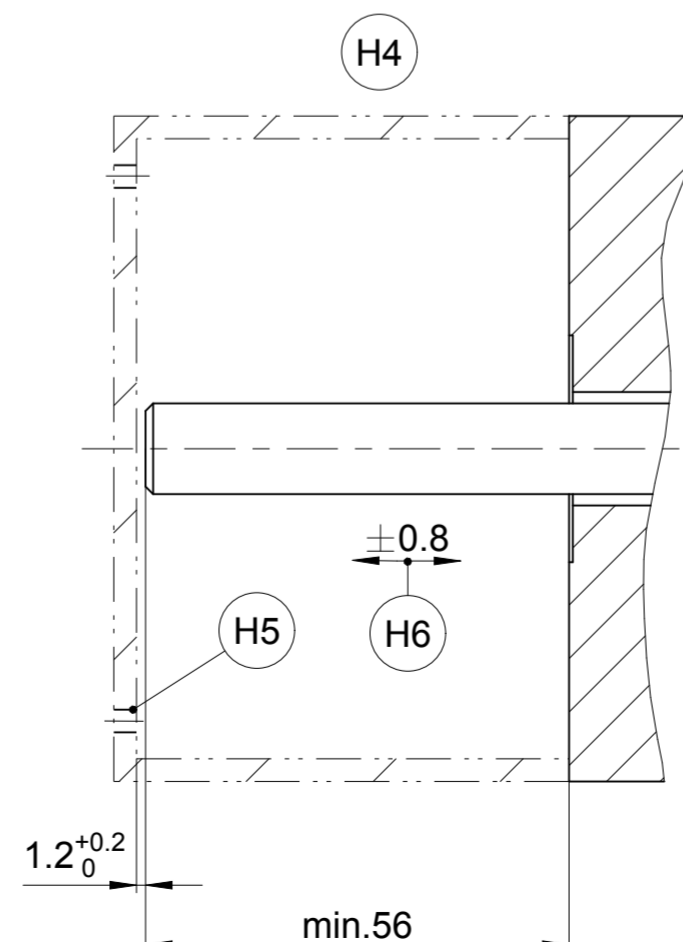
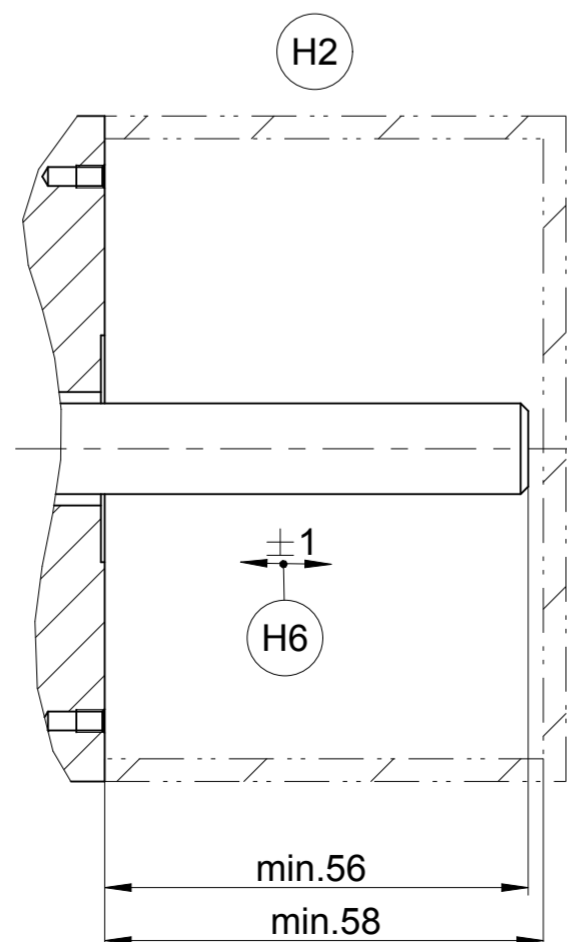
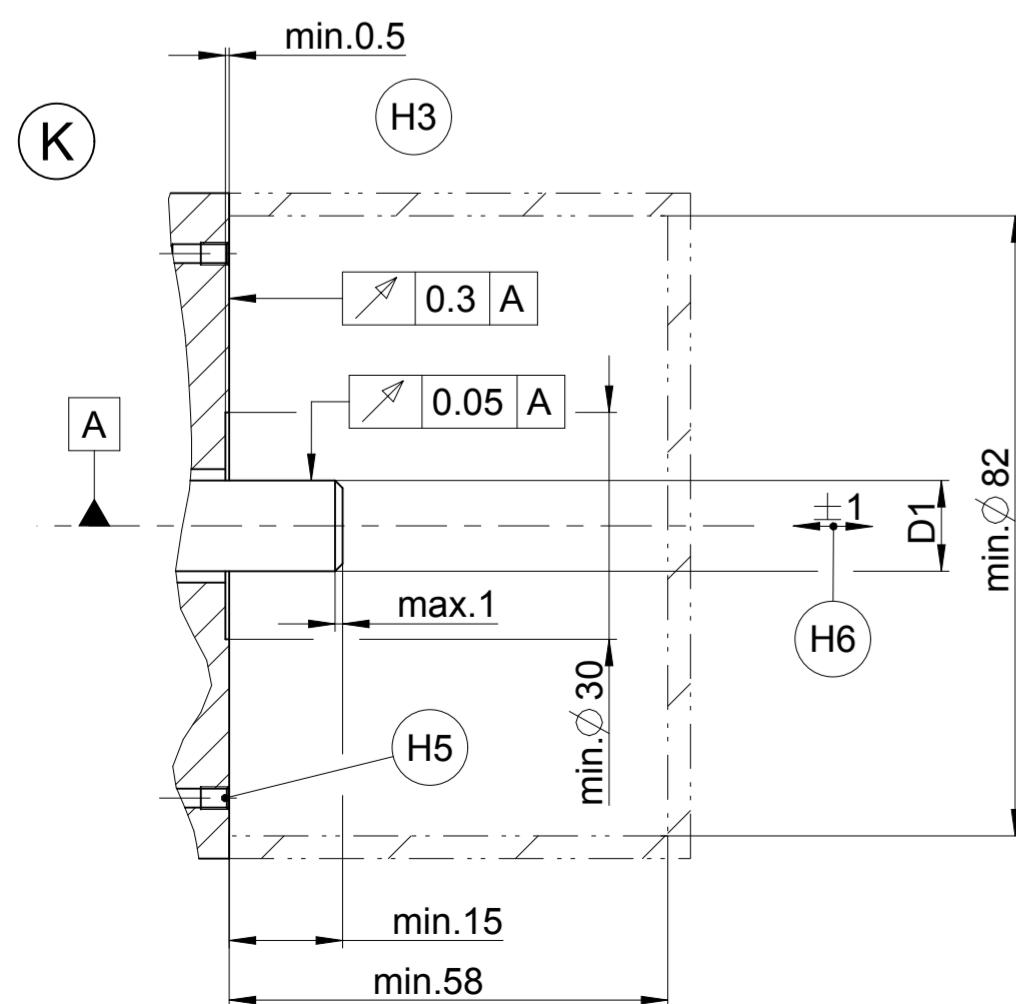

∅ 14 g7(E)	∅ 14 H7(E)	70E	46
∅ 12 g7(E)	∅ 12 H7(E)	70C	46
∅ 10 g7(E)	∅ 10 H7(E)	70B	46
∅ 9,52 g7(E)	∅ 9,52 H7(E)	70D	46
∅ 8 g7(E)	∅ 8 H7(E)	70A	46
D1	D2	WELLA1	KUPPA1

Original drawing Scale: 1:1 Format: A2		ECN/EQN 4xx AMZ Kundenseitig ECN/EQN 4xx Anschlussmaße / Mounting Dimensions		ID number: Change No. C042382-05 Phase: Serie	
		Tolerierung nach DIN ISO 8015 Tolerances as per DIN ISO 8015 Allgemeintol. ISO 2768-mH ∓6mm:±0,2 General tol. ISO 2768-mH ∓6mm:±0,2		Version Revision Sheet Page D 541101-05-A-01 1 of 1 Document number	

The reproduction, distribution and utilization of this document as well as the communication of its contents to others without express authorization is prohibited. Offenders will be held liable for the payment of damages. All rights reserved in the event of the grant of a patent, utility model or design. (ISO 16016)

HEIDENHAIN
DR. JOHANNES HEIDENHAIN GmbH
83301 Traunreut, Germany