

Darstellung ohne Limitblende und Fixpunkt

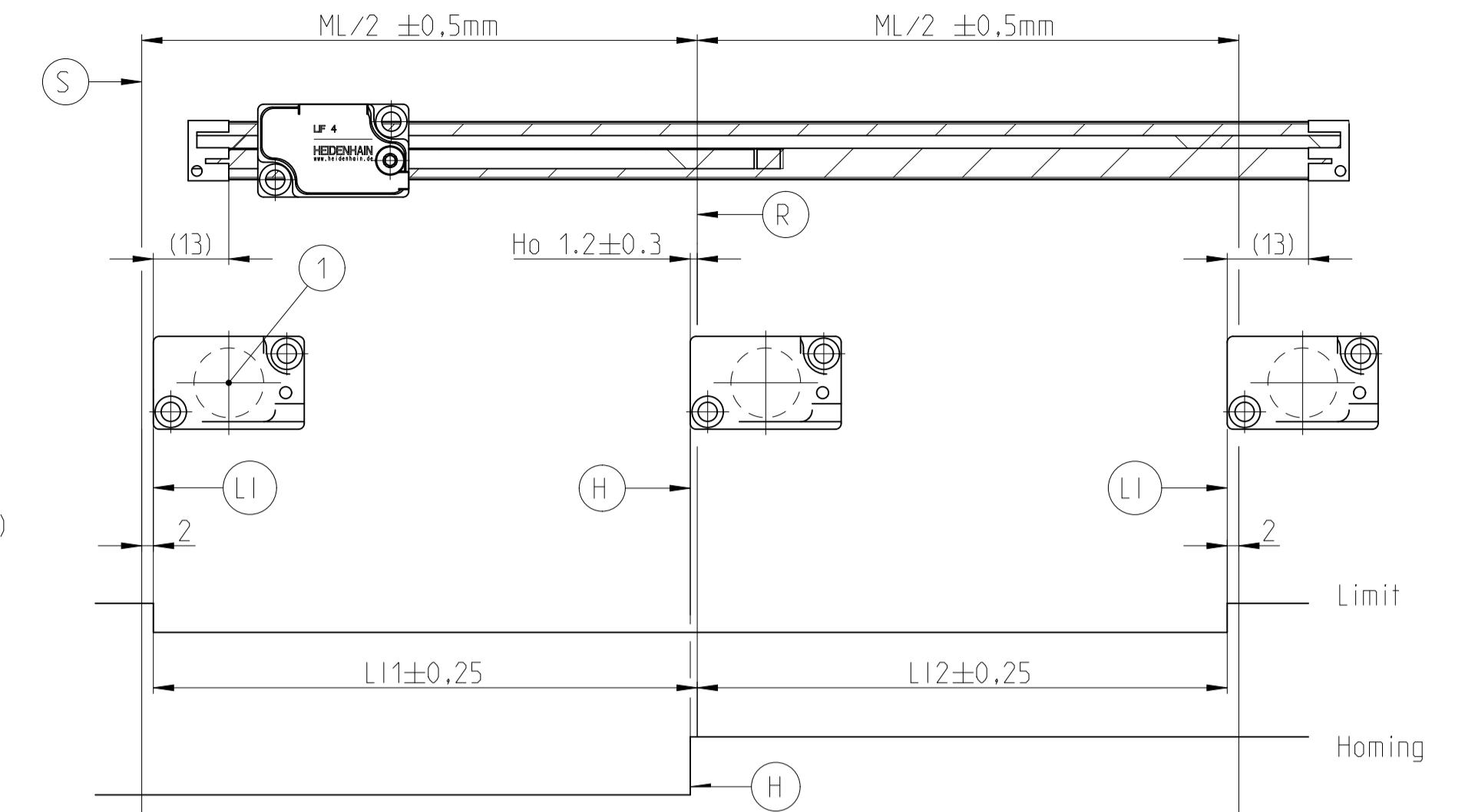

- L = Maßstablänge / scale length
- F = Maschinenführung / Machine guideway
- \* = max. Änderung bei Betrieb / Max. change during operation
- ML = Messlänge / Measuring length
- (E) = Vakuikleber, Aushärtung bei Raumtemperatur in 24 h / Vacuum glue, curing at room temperature in 24 h
- (LI) = Limit, verstellbar / Limit-label, adjustable
- (H) = Schalter für Homingspur / Switch for homing track
- Ho = Schaltpunkt Homing / Trigger point homing
- (R) = Referenzmarken-Lage / Reference mark position
- (S) = Beginn der Messlänge / Begin of measuring length
- (M) = Montagefläche für AK / Mounting surface for AK
- (G) = Fixpunktelement / Fixed-point
- (H) = Homing Schaltflanken / Homing edge
- (1) = optische Mitte / Optical center
- (2) = Abstand Abtastkopf / Maßstab / Mounting gap
- (3) = positive Messrichtung / positive direction
- (4) = Abstand mit Folie einstellen / adjusted by means of a space shim
- (5) = zusätzliches Spannpratzenpaar abhängig von ML / additional fixing clamp pair depending on ML

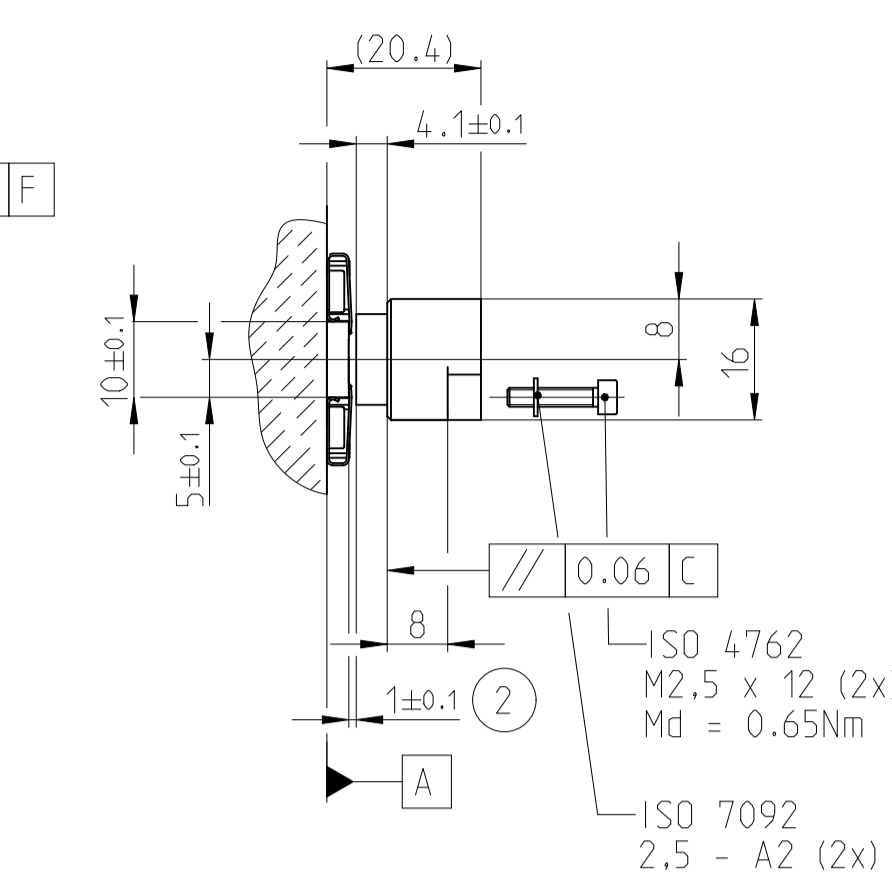
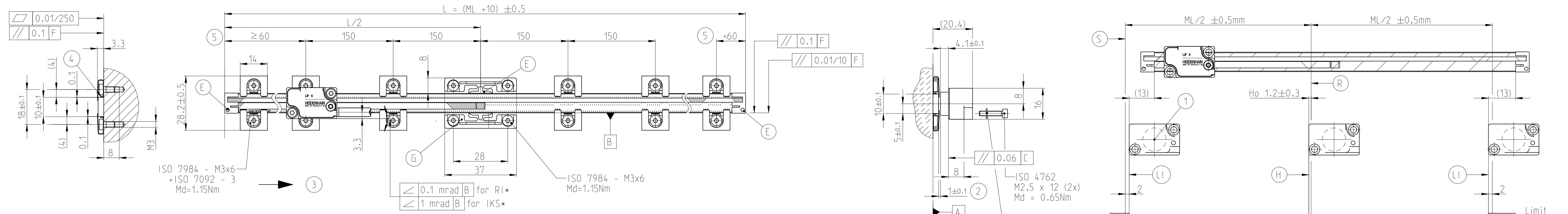
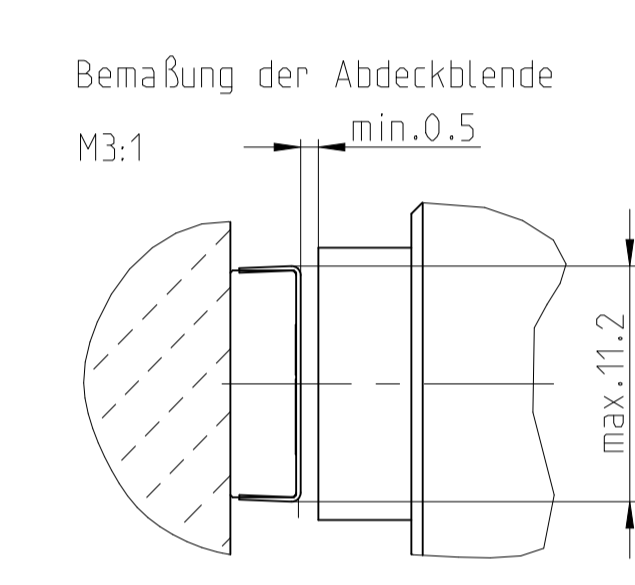
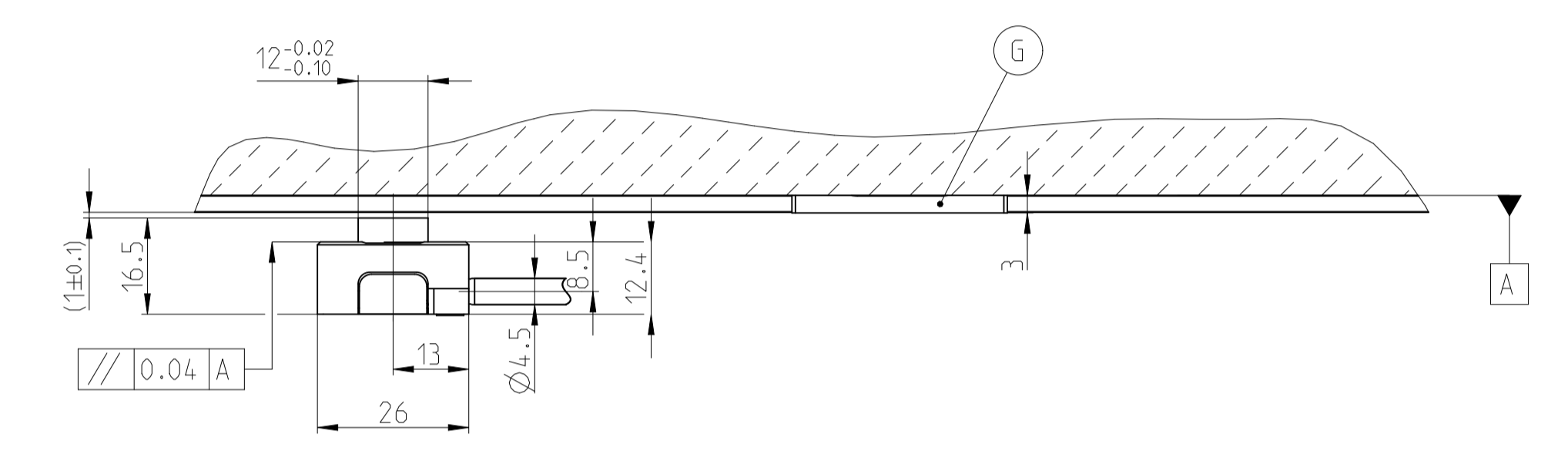
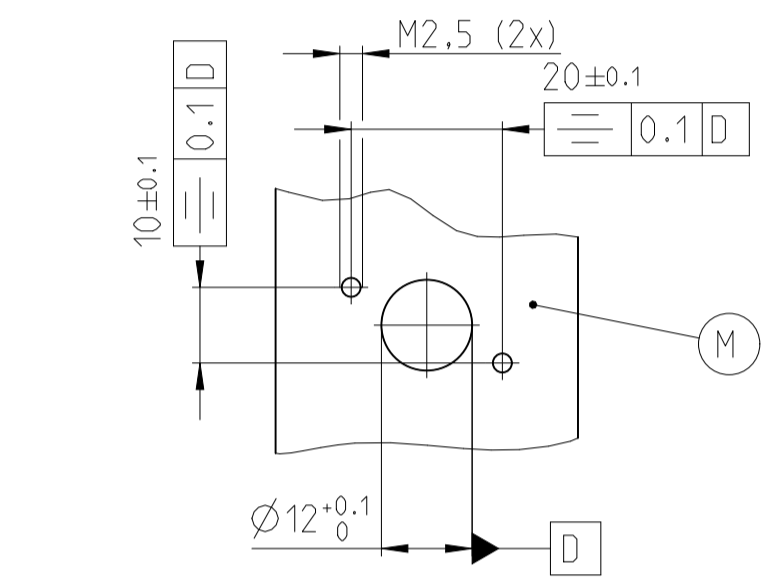

Position Anschlagstifte  
Position stop pins

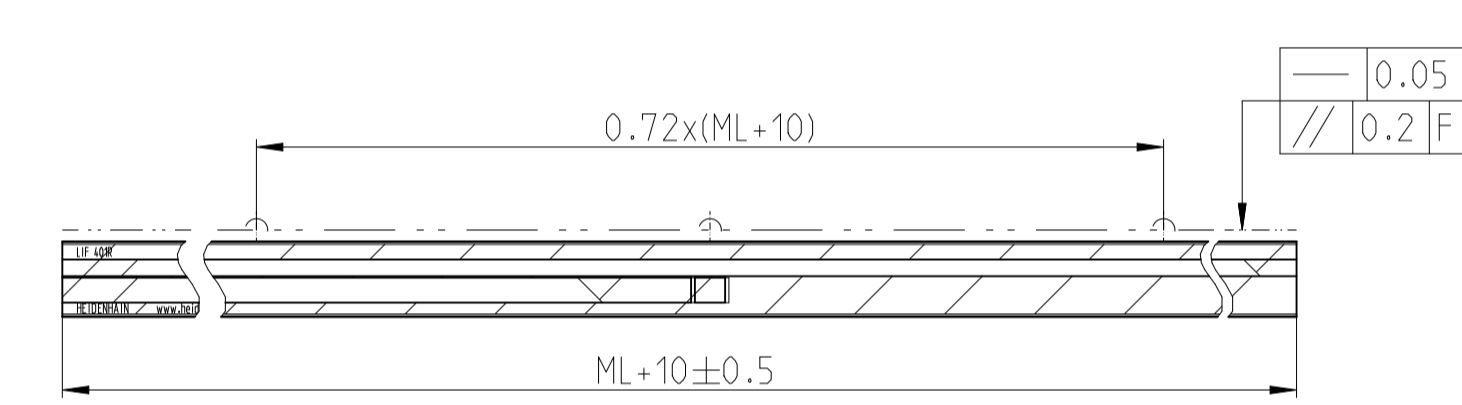

← Vakuum / SubD 15pol. Bu  
Luft / air - side → / SubD 15pol. Bu

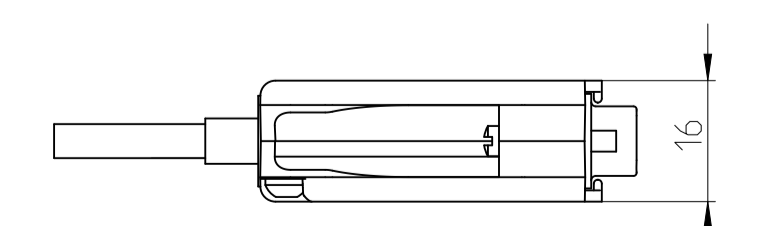
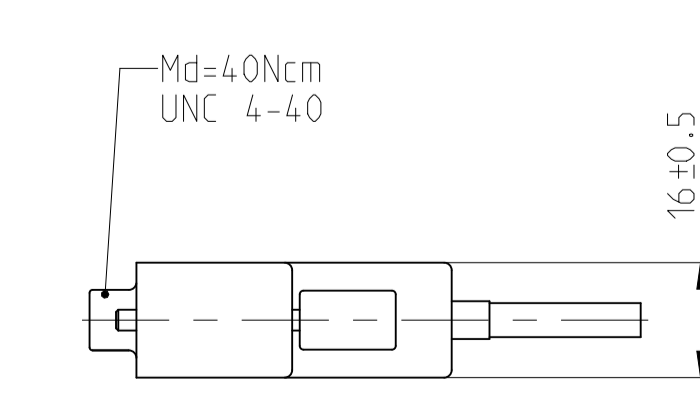
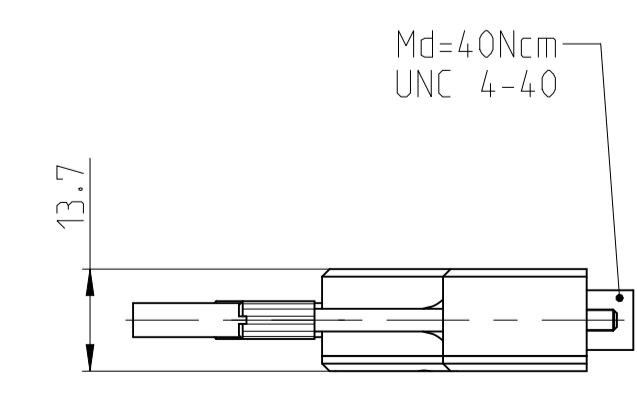
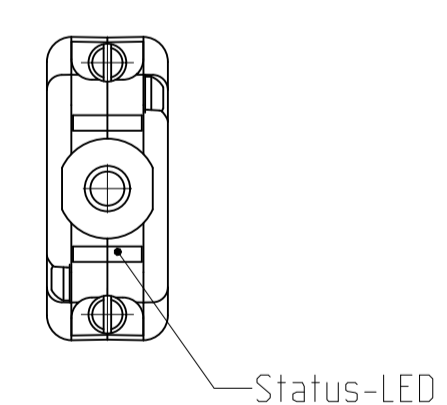
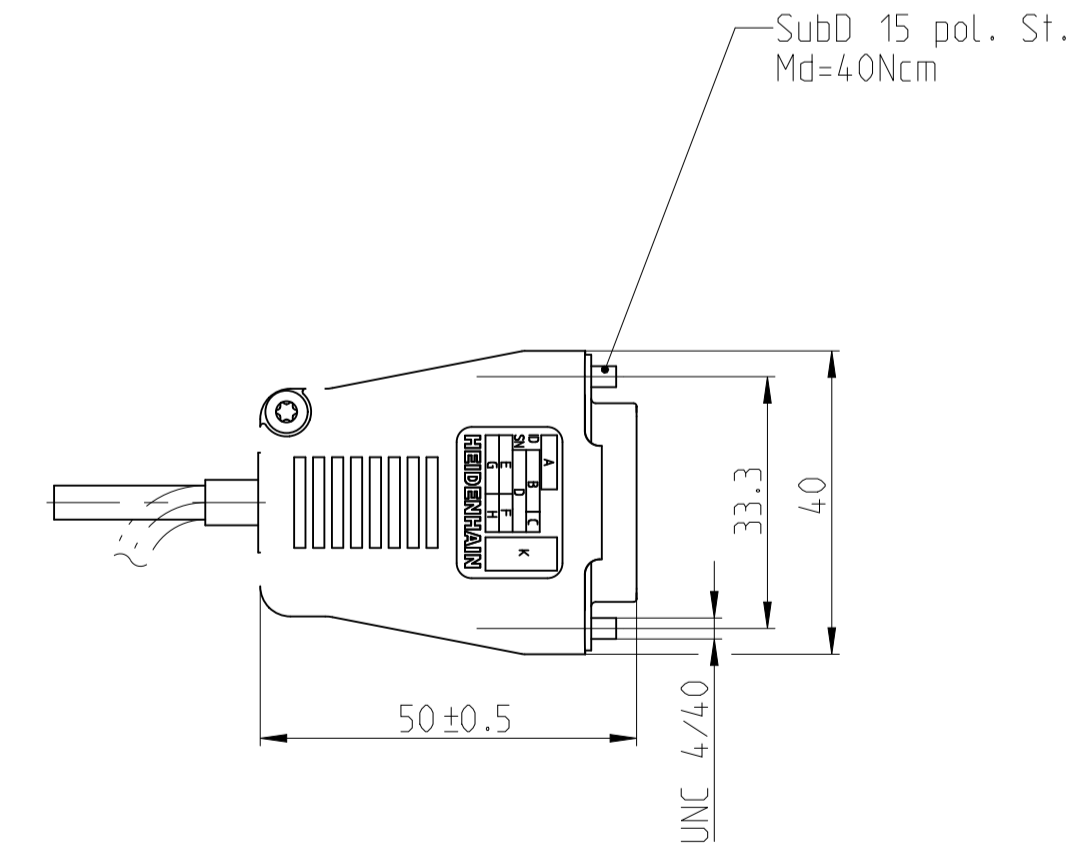
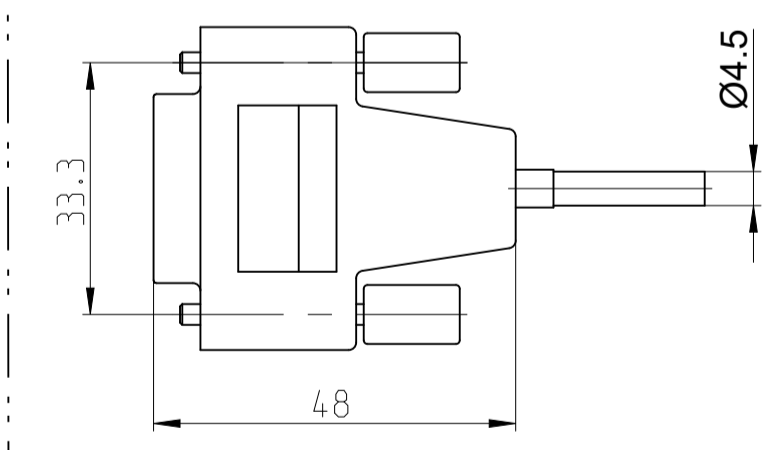
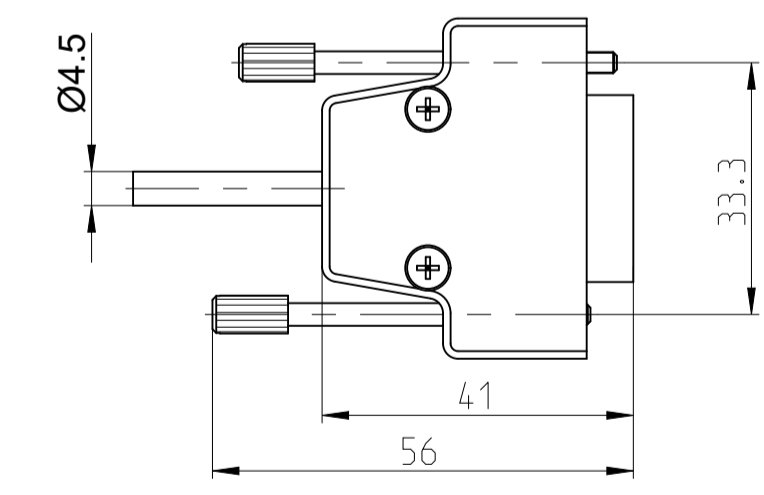
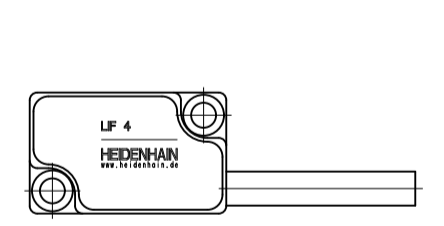

Original drawing		Scale		Format		AK LIF48U SUB-D AK LIF48U SUB-D Anschlussmaße / Mating Dimensions		ID number: C142282-02
Dimensions in mm		1:1		A1				Change No. Serie
								Tolerances as per ISO 8015
								General Tolerances ISO 2768-1989-mH ±0.2
								Released
								Version / Revision / Sheet / Page
								14.12.2023
								D1383387-00-A-01
								1 of 1

**HEIDENHAIN**  
DR. JOHANNES HEIDENHAIN GmbH  
83301 Traunreut, Germany