

- (K) = Kundenseitige Anschlussmaße Required mating dimensions
- (H1) = Flanschdose M12 - 8-pol. Flange socket M12, 8-pin.
- (H2) = Justiermarke Alignment mark

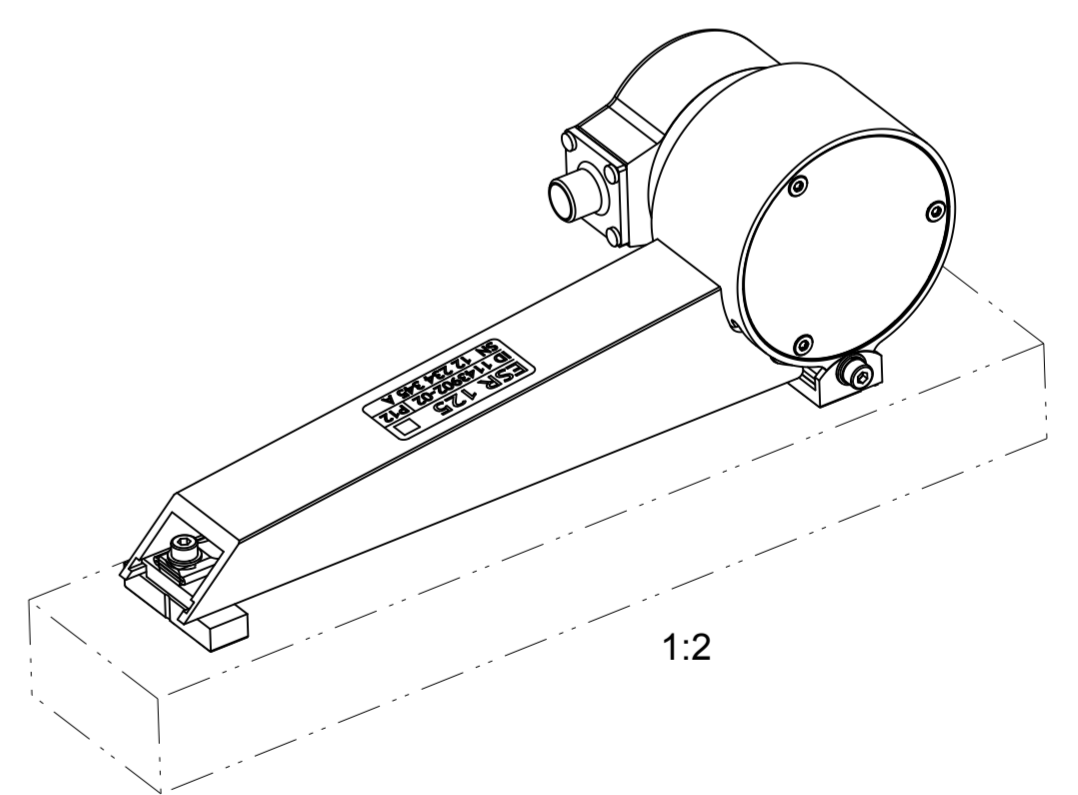

Original drawing		ESR 425		ID number:
Scale		ESR 425		Change No. C053970-30
Format		Anschlussmaße / Mating Dimensions		Phase: Serie
Dimensions in mm	1:1	A2		Tolerierung nach DIN ISO 8015
				Allgemeintol. ISO 2768-mH $\pm 0,2$
				General tol. ISO 2768-mH $\pm 0,2$
The reproduction, distribution and utilization of this document as well as the communication of its contents to others without express authorization is prohibited. Offenders will be held liable for the payment of damages. All rights reserved in the event of the grant of a patent, utility model or design. (ISO 16016)				
LEINE LINDE SYSTEMS			Version	Revision
LEINE LINDE SYSTEMS GmbH 20457 Hamburg, Germany			Sheet	Page
			D1247481-00 - B-01	1 of 1
			Document number	