

SL, SR = segment length / Segmentlänge
 ≥ 20 ... ≤ 1000 = 1x remnant / Reststück (≥ 20 ... ≤ 1000)
 > 1000 ... ≤ 1500 = 1x 499,5 + 1x remnant / Reststück (> 500 ... ≤ 1000)
 > 1500 ... ≤ 2000 = 1x 999,5 + 1x remnant / Reststück (> 500 ... ≤ 1000)
 > 2000 ... ≤ 2500 = 1x 499,5 + 1x 999,5 + 1x remnant / Reststück (> 500 ... ≤ 1000)
 > 2500 ... ≤ 3000 = 2x 999,5 + 1x remnant / Reststück (> 500 ... ≤ 1000)
 > 3000 ... ≤ 3500 = 1x 499,5 + 2x 999,5 + 1x remnant / Reststück (> 500 ... ≤ 1000)
 etc.

M = machine guideway / Maschinenführung
 ML = measuring length / Messlänge
 OL = overall length / Gesamtlänge
 ↔ = 0 ... ML
 ⊙ = beginning of the measuring length / Beginn der Messlänge
 RI = reference mark(s) / Referenzmarke(n)
 k = any position of selected reference mark starting from the beginning of the ML
 beliebige Position der ausgewählten Referenzmarke vom Beginn der ML
 j = additional reference marks spaced n x 50
 zusätzliche Referenzmarken im Abstand von n x 50
 f = OL/2 (standard)
 any position of the clamping element (optional)
 beliebige Position des Klemmelements (optional)
 C = cable / Anschlusskabel
 K = required mating dimensions / kundenseitige Anschlussmaße
 L = LED function control / LED Funktionskontrolle
 R = bending radius / Biegeradius
 stat. R ≥ 8mm, dyn. R ≥ 20mm
 S1, S2 = switch signal / Schaltsignal
 n = 1,2,3,...

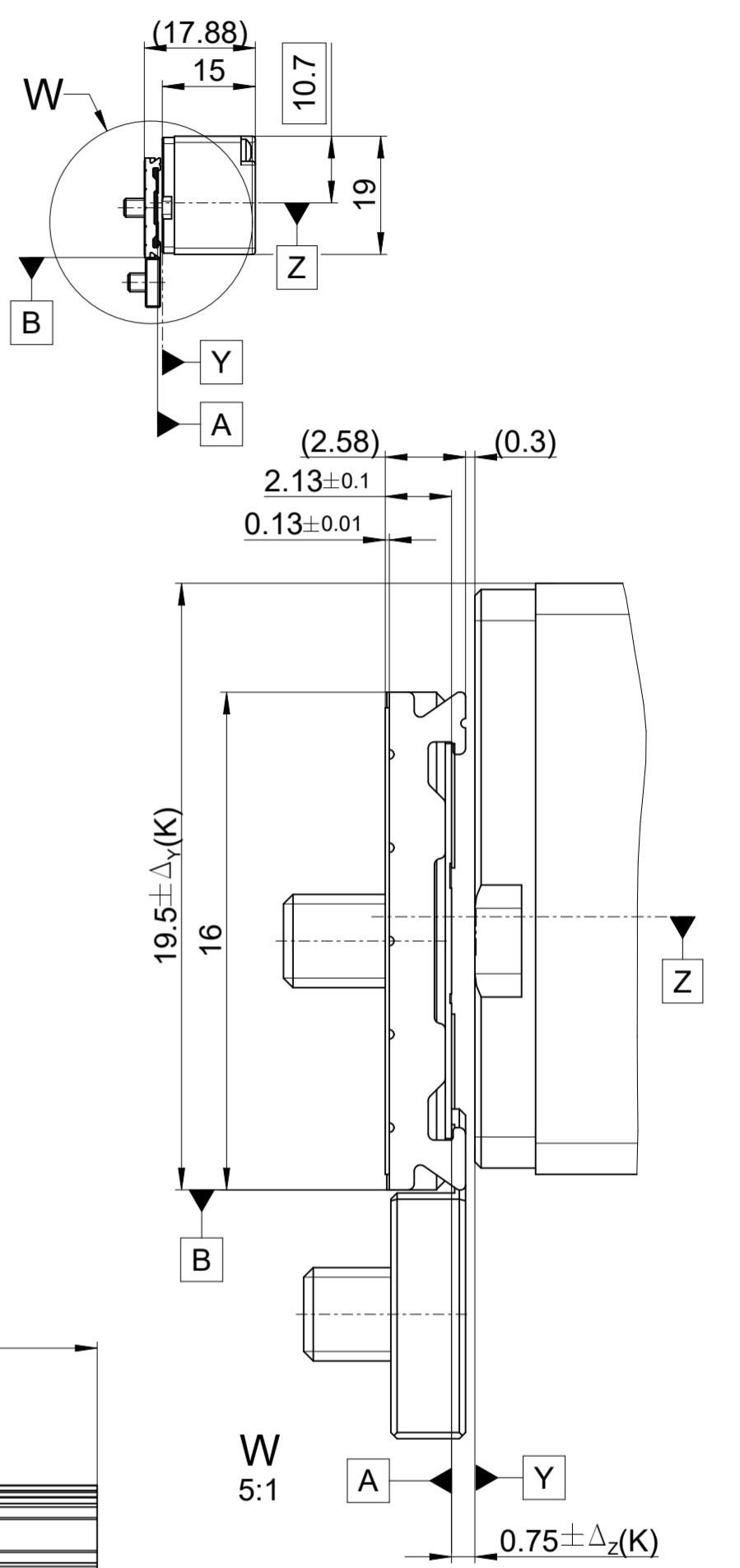
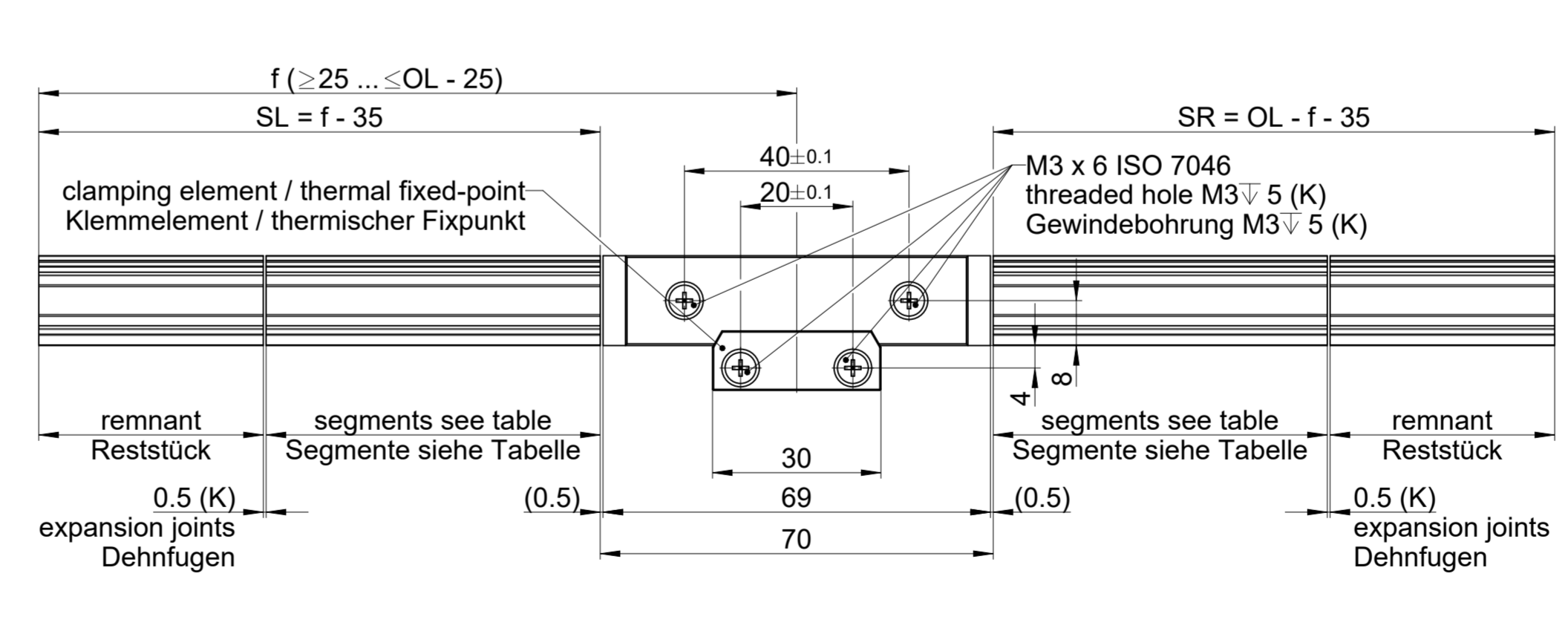

Permissible position deviation scanning head - scale tape A B
 Zulässige Lageabweichungen Abtastkopf - Maßband A B

Δ_z = +0.20mm / -0.15mm (gap / Abstand)

Δ_y = ± 0.5mm (lateral / Verschiebung)

φ_z = ± 0.25mrad or / oder ± 0.014° (yaw angle / Gierwinkel)

φ_y = ± 5.00mrad or / oder ± 0.29° (pitch angle / Nickwinkel)

φ_x = ± 5.00mrad or / oder ± 0.29° (roll angle / Rollwinkel)

| | | | | | |
|---|-----|-----------------------------------|---|----------------------------|--------------|
| Original drawing | | MS35 MP | | ID number: | C157360-13 |
| Scale | | MS35 MP | | Change No. | Phase: Serie |
| Format | | Anschlussmaße / Mating Dimensions | | Tolerances as per ISO 8015 | |
| Dimensions in mm | 1:1 | A2 | General Tolerances ISO 2768:1989-mH ≤ 6±0.2 | | |
| The reproduction, distribution and utilization of this document as well as the communication of its contents to others without express authorization is prohibited. Offenders will be held liable for the payment of damages. All rights reserved in the event of the grant of a patent, utility model or design. (ISO 16016) | | | | | |
| Released | | Version / Revision | | Sheet | Page |
| 01.12.2023 | | D1211142-02 - A-01 | | 1 | 1 |
| Document number | | | | | |

