

Fixpunktklebung
Fixed-point bond

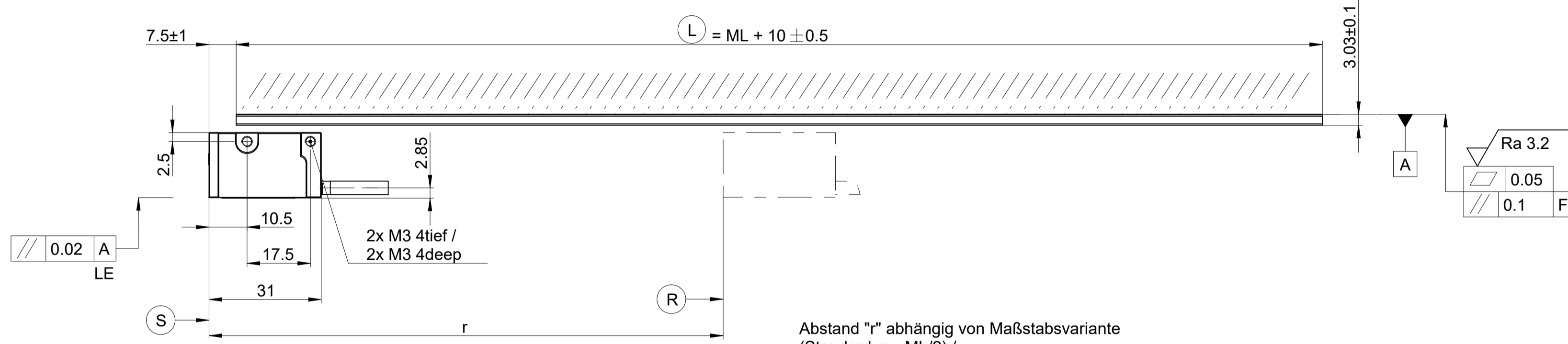

Bei mittigem Anschlagstift
With stop pin at center

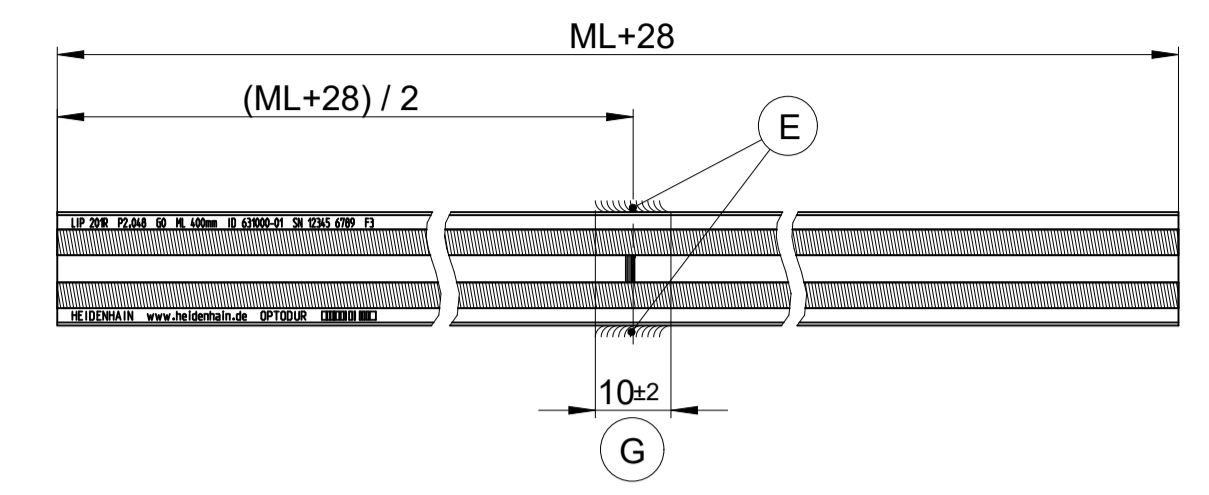
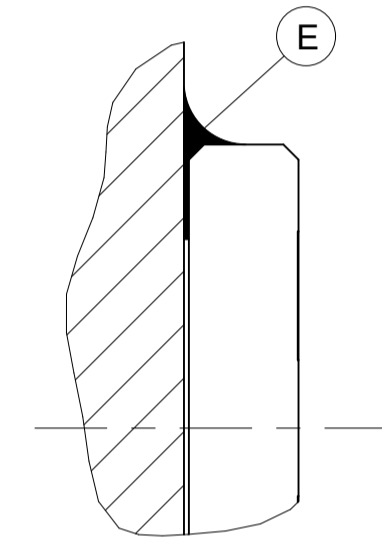
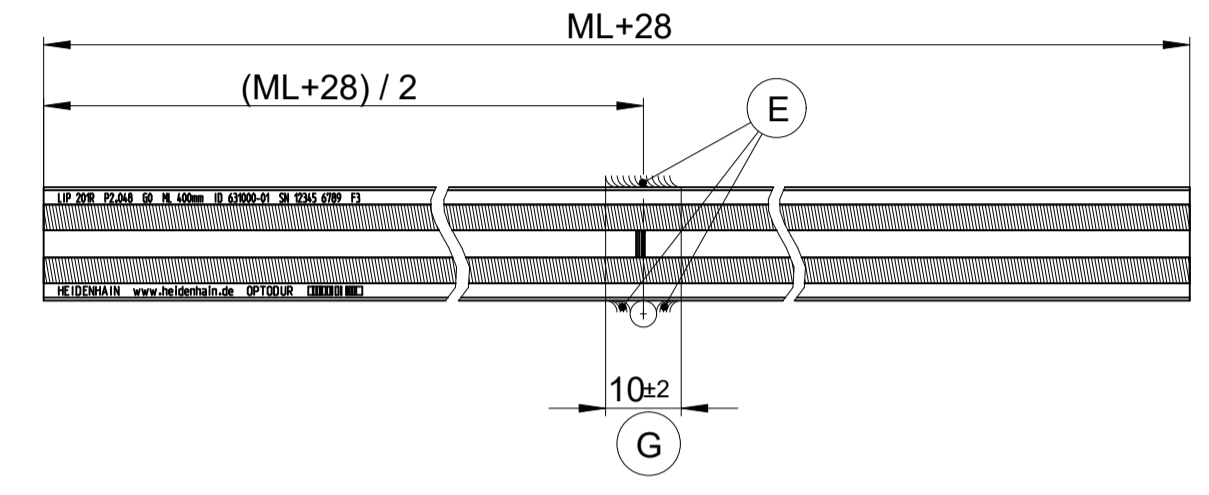

Abstand "r" abhängig von Maßstabsvariante
(Standard: r = ML/2) /
Distance "r" depends on the scale variant
(Standard: r = ML/2)

Anbaumöglichkeiten Abtastkopf /
Mounting options encoder head

Position Anschlagstifte
Position stop pins

ML ≤ 2040

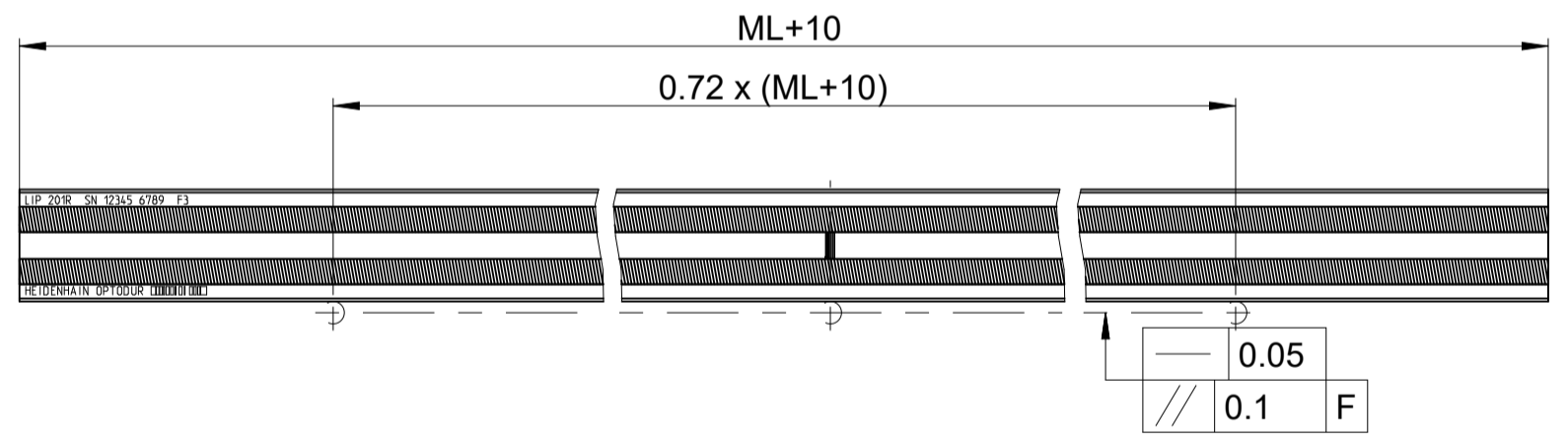

ML > 2040

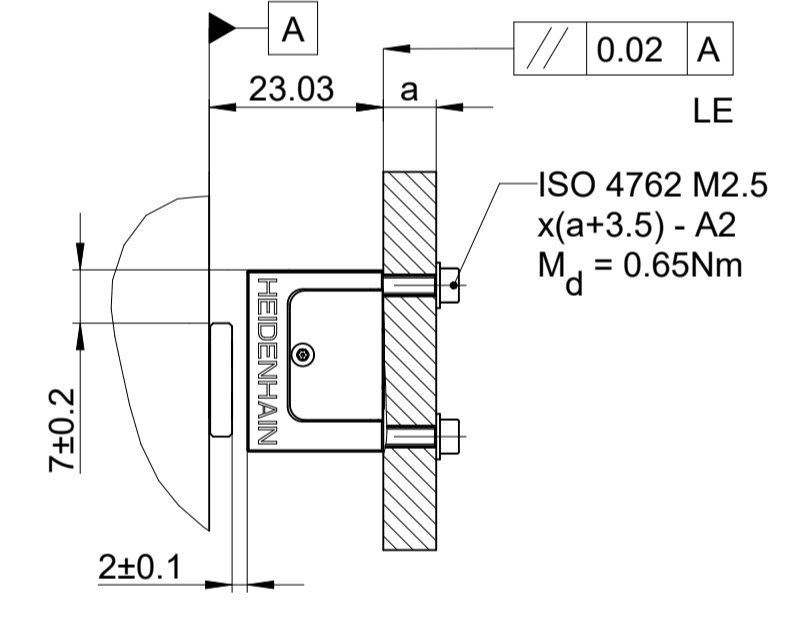
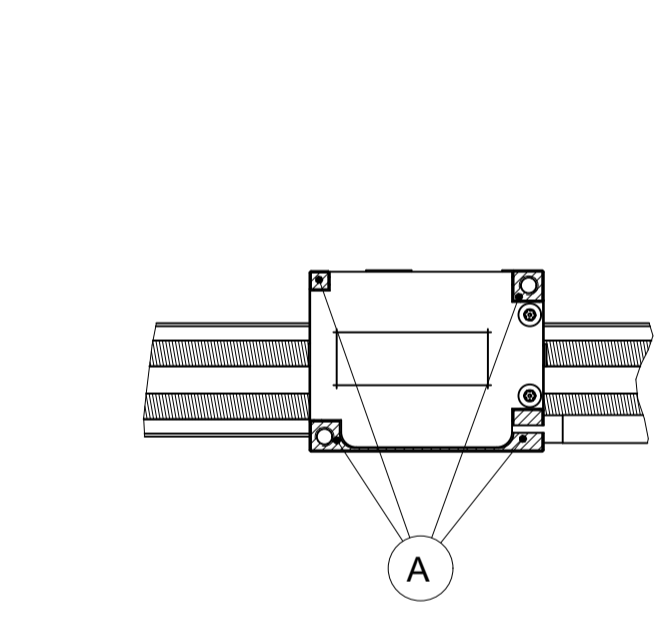
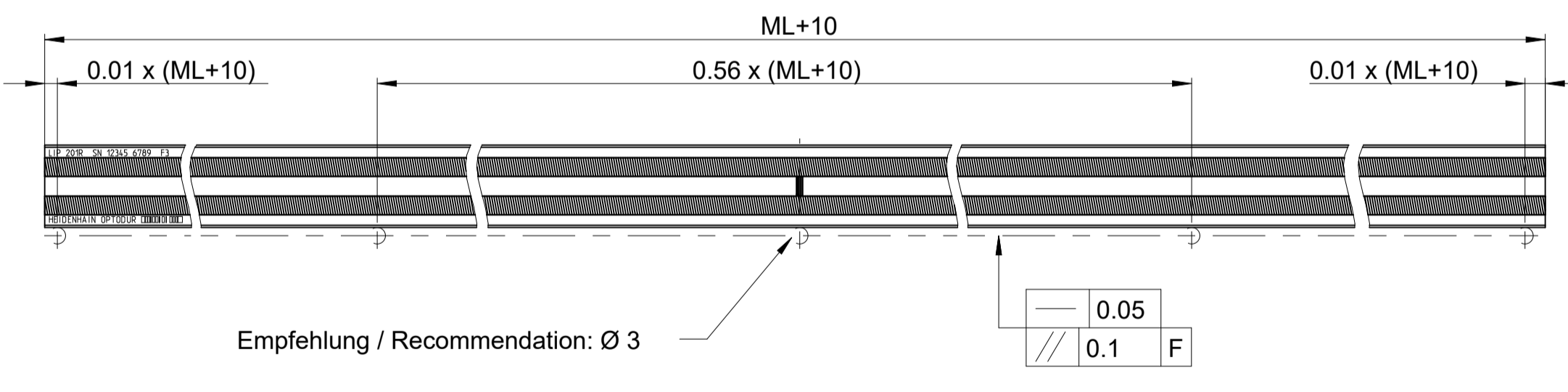

Ver. A

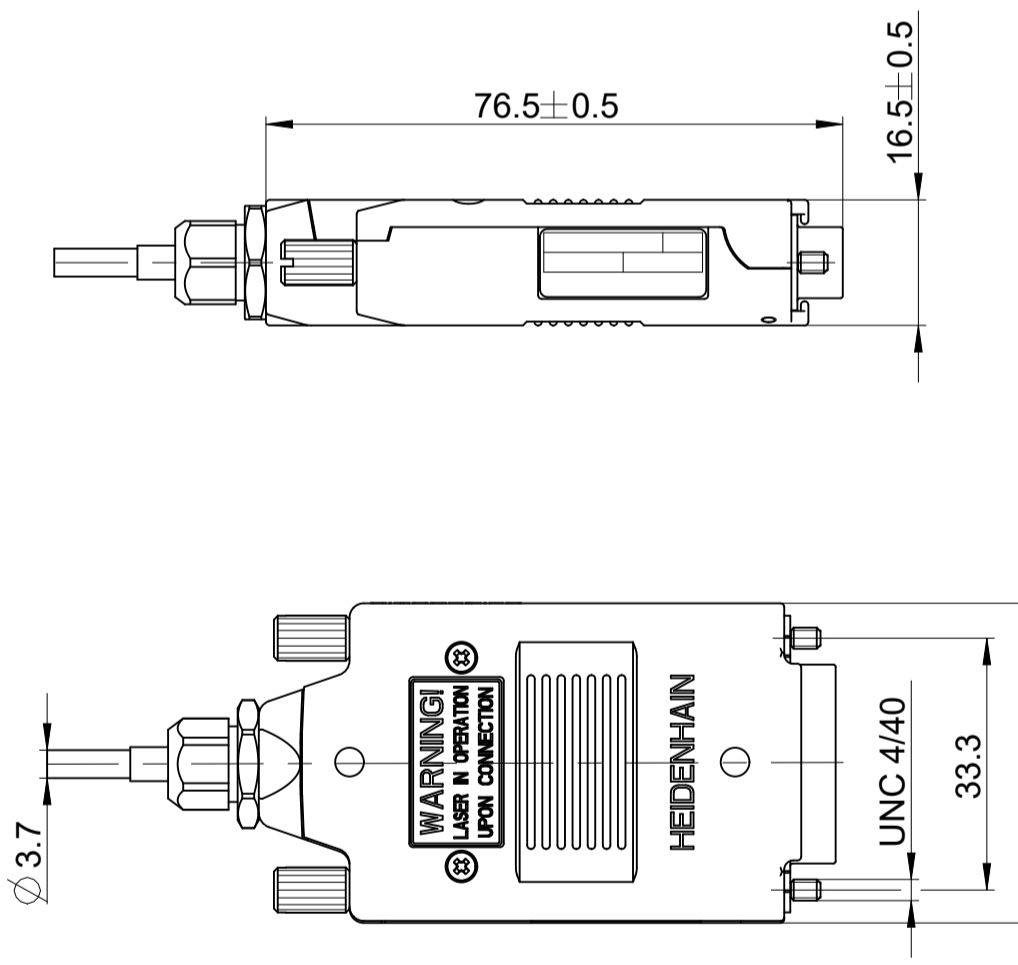

Ver. B

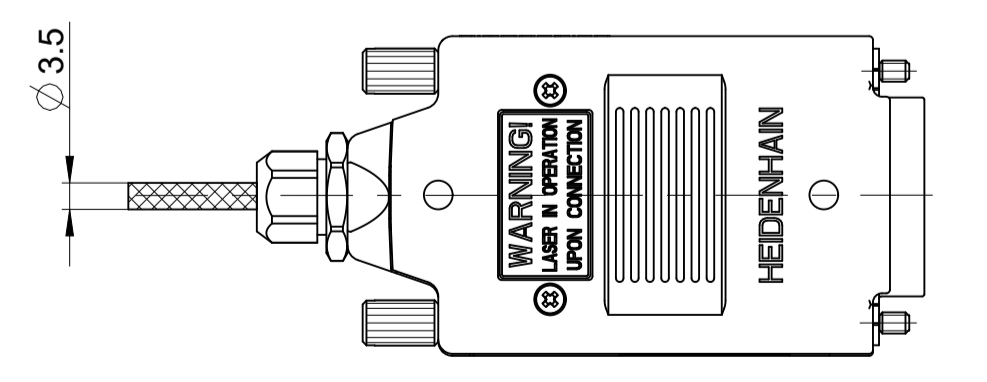

- F = Maschinenführung / Machine guideway
- R = Referenzmarken-Lage / Reference mark position
- L = Maßstablänge / Scale length
- S = Beginn der Messlänge ML / Beginning of measuring length
- E = Klebstoff gem. Montageanleitung / Adhesive as per the mounting instructions
- G = Dosierlänge / Dosage length
- H2 = Überstand Schraubenkopf max. 0,5mm / Max. protrusion of screw head 0,5mm
- A = Anbaufläche / Mounting surface
- = Bewegungsrichtung des Abtastkopfs für Ausgangssignale gemäß Schnittstellen-Beschreibung / Positive direction of scanning head movement for output signals in accordance with interface description

Electronics housing	ID number
Ver. A	1063024
Ver. A	1035059
Ver. B	1035058
Ver. A	1035051
Ver. B	814014
Ver. A	680600

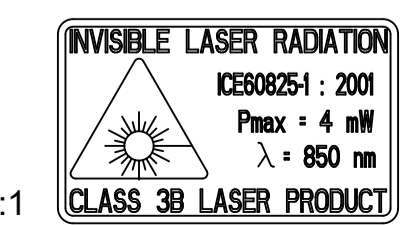

Original drawing		ID number: 680600	
Scale	Format	Change No.	C046788-10
1:1	A1	Phase:	Serie
Dimensions in mm		Tolerierung nach DIN ISO 8015 Tolerances as per DIN ISO 8015	
LIP 2x1 geklebt LIP 2x1 with adhesive film		Allgemeintol. ISO 2768-mH 36mm±0.2 General tol. ISO 2768-mH 36mm±0.2	
Anschlussmaße / Mating Dimensions		Version Revision Sheet Page	
HEIDENHAIN DR. JOHANNES HEIDENHAIN GmbH 83301 Traunreut, Germany		D1195501-00-A-01 Document number	