

Required mating dimensions

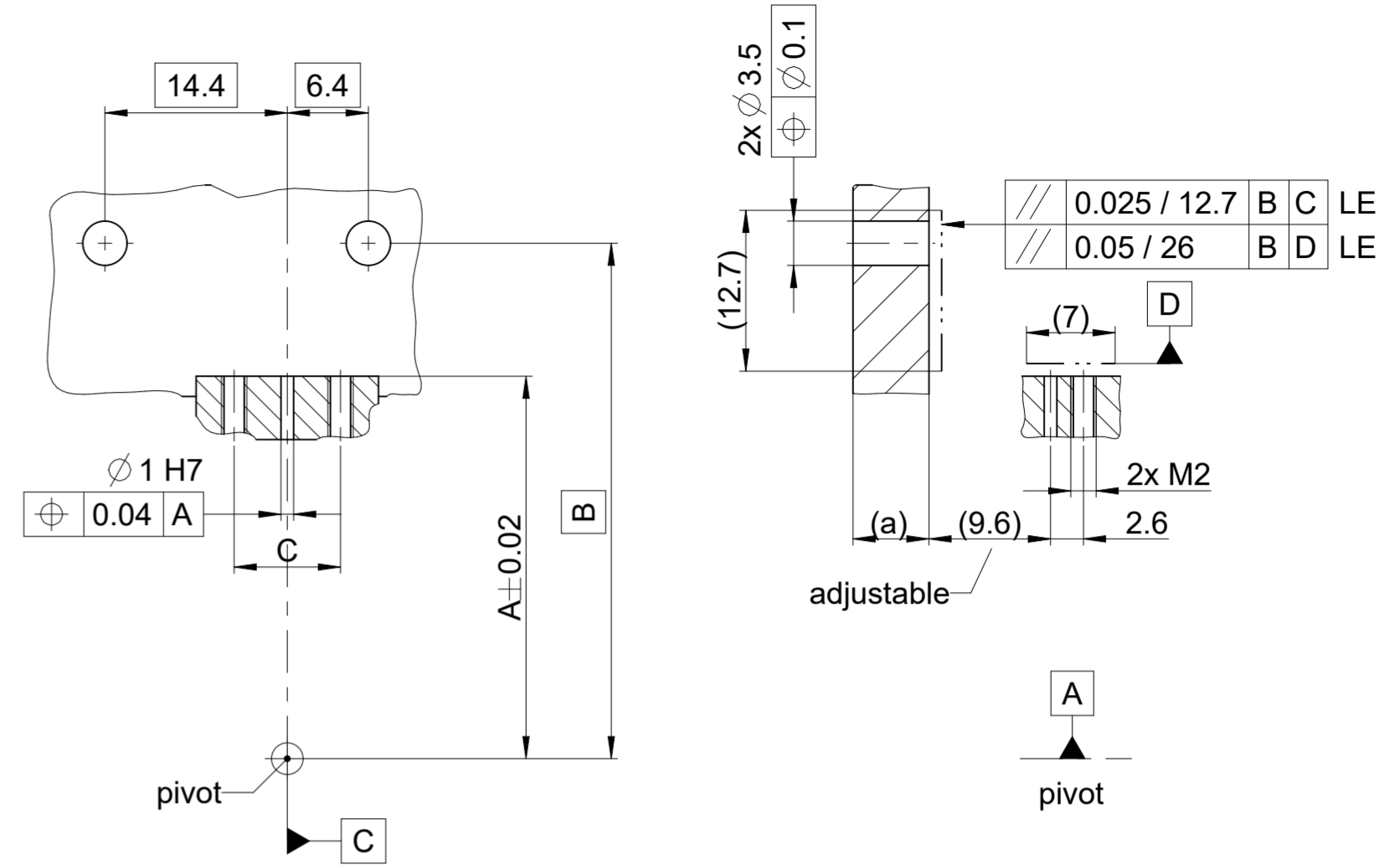

signal periods / 360°	23000 SP			30000 SP			50000 SP			63000 SP		
	MR	MR*	A	MR	MR*	A	MR	MR*	A	MR	MR*	A
MR	10°	23°	36°	8°	16°	31°	5°	11°	21°	4°	8°	15°
MR*	6.6°			5.2°			3.2°			2.4°		
A	20.98			30.2			46.95			67.95		
B	31.48			40.7			57.45			78.45		
C	5	8.4	13	5	8.4	13	5	8.4	13	5	8.4	13
D	10	13.4	22.9	10	13.4	22.9	10	13.4	22.9	10	13.4	22.9

MR*: required range to start-up the system with "ATS - Adjusting and Testing Software"

Mounting tolerances; given tolerances in combination

signal periods	23000 SP	30000 SP	50000 SP	63000 SP
X	adjustable, see H2			
Y	adjustable, see H2			
Z	±0.1			
Rx	±2mrad			
Ry	±2mrad			
Rz	adjustable, see H2			

- A = pivot
- H1 = Positive direction of rotation
- H2 = Fine-adjustment of encoder-head to reach best incremental signal (within "play" of the mounting screws); given measures are nominal
- R = Position reference mark

For adjustment of encoder head - optional:
Use dowel pin Ø 2 to find start position, if necessary remove pin to reach best incremental signal

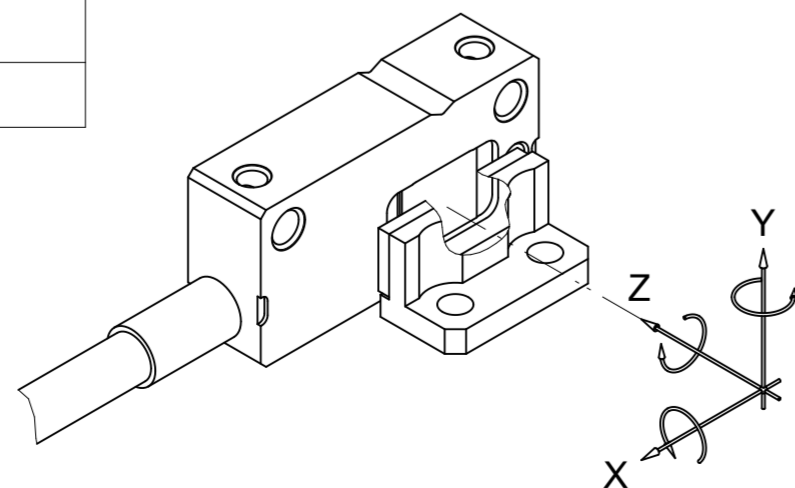
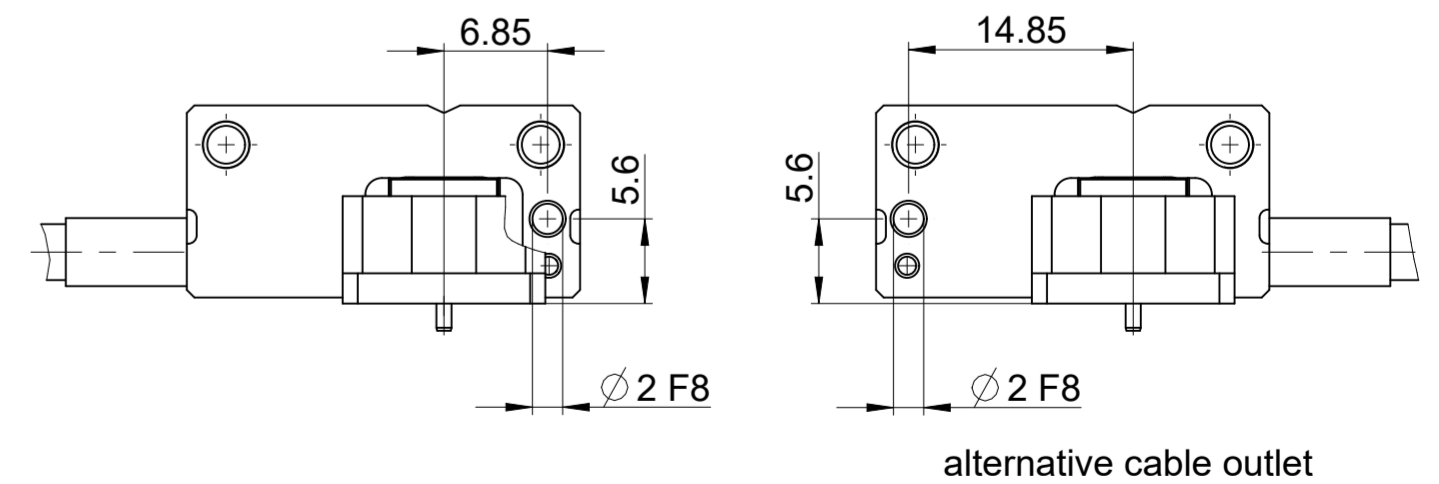

Original drawing		Scale		Format		ERP 10x2		ID number:	
2:1		A2		Anschlussmaße / Mating Dimensions		ERP10x2		C101796-05	
Dimensions in mm								Phase: Serie	
								Tolerierung nach DIN ISO 8015	
								Tolerances as per DIN ISO 8015	
								Allgemeintol. ISO 2768-mH ±6mm:±0,2	
								General tol. ISO 2768-mH ±6mm:±0,2	
								The reproduction, distribution and utilization of this document as well as the communication of its contents to others without express authorization is prohibited. Offenders will be held liable for the payment of damages. All rights reserved in the event of the grant of a patent, utility model or design. (ISO 16016)	
								Version Revision Sheet Page	
								1 1	
								D1160658-01-A-01	
								Document number	