

KABEA2	A
01	∅ 4.5
02	∅ 6

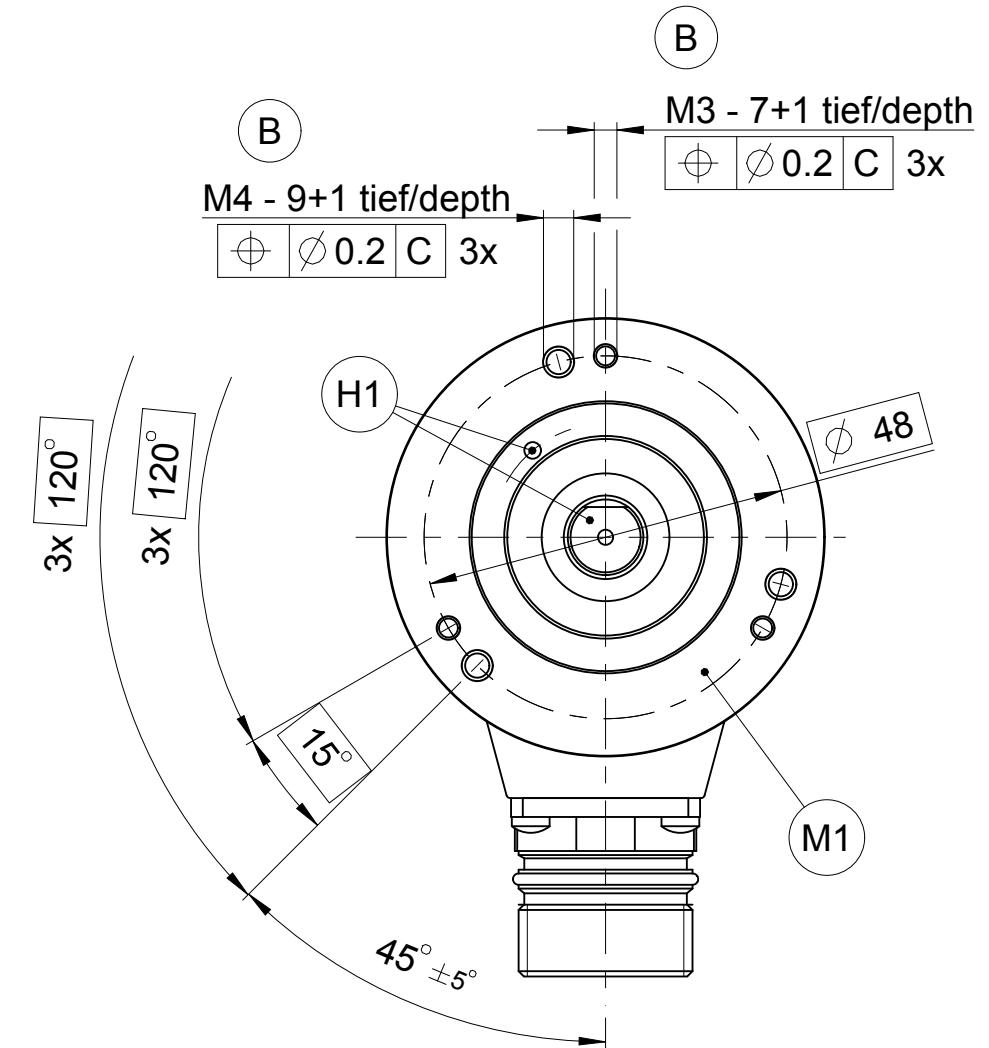

- A** = Lagerung Geber                      Bearings for encoder
- B** = Befestigungsgewinde              Threaded mounting hole
- M1** = Messpunkt Arbeitstemperatur    Operation temperature measuring point
- M2** = Vibrationsmesspunkt s. D741714    Vibration measuring point s. D741714
- H1** = ROD Referenzmarkenlage        ROD reference mark position  
Welle - Flansch ± 15°                      shaft - flange ± 15°

Werkstückkanten nach ISO 13715  
Workpiece edges ISO 13715

01J	39A	ID number:
03D	39A	
WELLA1	FLANA1	Phase: Serie
		<b>ROD/ROC/ROQ 4xx</b> <b>ROD/ROC/ROQ 4xx</b> Anschlussmaße / Mounting Dimensions
Dimensions in mm	Scale: 1:1    Format: A2	
		Allgemeintol. ISO 2768-mH ∓6mm:±0,2 General tol. ISO 2768-mH ∓6mm:±0,2
The reproduction, distribution and utilization of this document as well as the communication of its contents to others without express authorization is prohibited. Offenders will be held liable for the payment of damages. All rights reserved in the event of the grant of a patent, utility model or design. (ISO 16016)		
<b>HEIDENHAIN</b>		Version   Revision   Sheet   Page
DR. JOHANNES HEIDENHAIN GmbH 83301 Traunreut, Germany		<b>D1064846-02 - A-01</b> Document number
		1 of 1