



Plahvatusohtlike alade pöördandur (ATEX).



PTB 08 ATEX 1094 X
II 2 G Ex db IICT 120 °C
II 2 D Ex tb IIIC T 120 °C

HEIDENHAIN

Paigaldusjuhend

ROC 413 EnDat01

ROC 413 SSI01r1

ROQ 425 EnDat01

ROQ 425 SSI07r1

WELLA1: 01J, 01A

FLANA1: 03C, 01C

3/2015

et

Sisukord

Hoiatusjuhised	3
Tarnemaht	8
Paigaldusmõõtmed / Paigaldus	10
Tehnilised omadused	18
Viikude jaotus	20

Võllitihendit mitte vigastada või eemaldada.

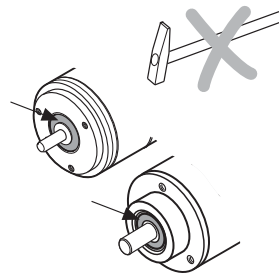

Töökaabel kindlalt paigaldada (tõmbetõkis).

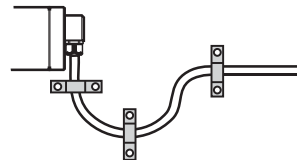

Mõõteseadet saata teeninduseks HEIDENHAIN-Service, Traunreut.

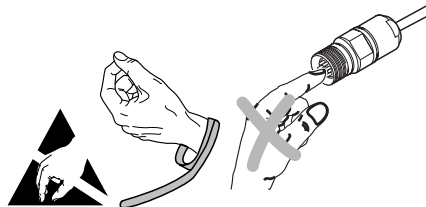

Tähelepanu: Paigalduse ja kasutuselevõtu peab teostama kvalifitseeritud spetsialist järgides kohalikke ohutuseeskirju.

Lisaks peab masinavalmistaja/-looja vajalikud täpsemad andmed lõpp-paigalduseks (nt turvamutri poltidele jah/ei) iga kasutuse jaoks ise kindlaks määrama.

Pistikühendust tohib vaid pingestamata ühendada või välja tõmmata.

Seade peab olema pingevabalt ühendatud!

$\overline{U_{aS}}$: Häiresignaal

$\overline{U_{aS}} = \text{High}$: ✓

$\overline{U_{aS}} = \text{Low}$: *



*) Häiresignaali nullimine toimub alles pärast anduri jahtumist.

Hoiatusjuhised

Ettevaatust: kui termolüliti temperatuur (integreeritud anduri äärikule) $> 100^{\circ}\text{C}$ ($\pm 5\text{ K}$), väljundsignaalid veel saadaval.

Termolüliti temperatuur alates 110°C ($\pm 5\text{ K}$) põhjustab toitepinge väljalülitumise. Töö asenditagastusega pole siis enam võimalik.

Kui kaabli kaitsekrae on võimalik väline koormus, tuleb paigaldada kaitsev kate [Ⓢ] (suunis 94/9/EG lisa II 1.2.5).

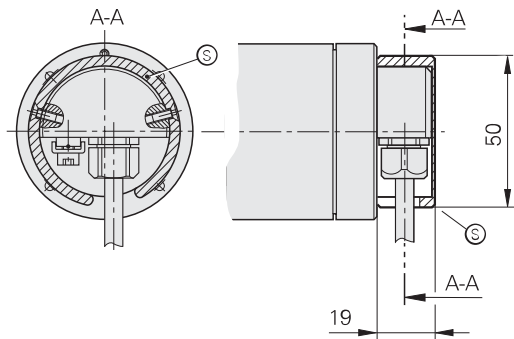

[Ⓢ] Kaitsev kate sisaldub tarnekomplektis

Tarnemaht

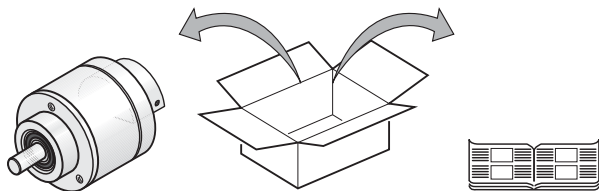

Eraldi tellimiseks



Montaažitugi
ID 581296-01



Montaažiäärrik
ID 201437-01

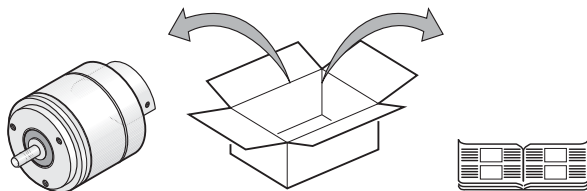
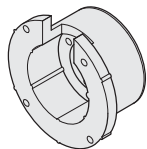

Membraanisidur K 17
ID 296746-xx

**Eraldi tellimiseks**

Montaažikell
ID 257044-01



Pingutusklambrid (3 tk vajalikud)
ID 200032-01

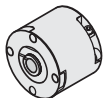

Membraanisidur K 17
ID 296746-xx

Paigaldusmõõtmed / Paigaldus

Paigaldusmõõtmed (mm)

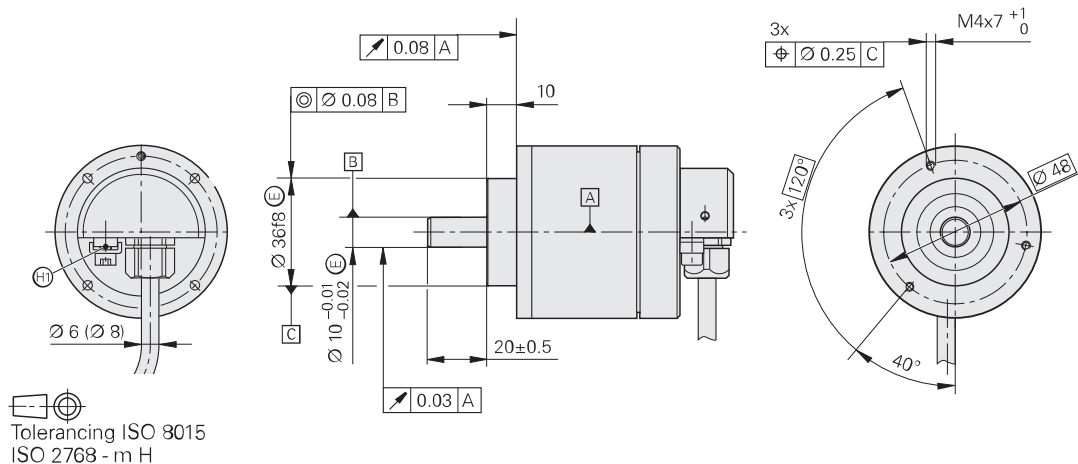

(H1) Maandus- ja potentsiaaliühtlustuse ühendusosa vastavalt DIN EN 60079-0

(A) Hoiustamine

Montaaž



Ettevaatust: Vigastusohht pöörlevate osade tõttu. Pange tähele puudutuskaitset!

Kontrollida võlli nihet

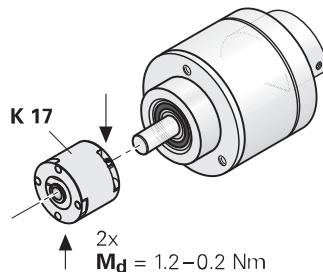
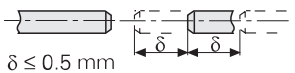
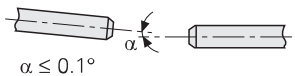
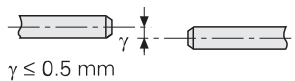

Montaaž

①, ②, ③ = Paigaldusvõimalused

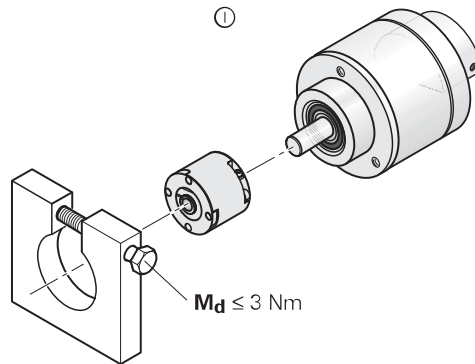

Võlliotsa maksimaalne koormus

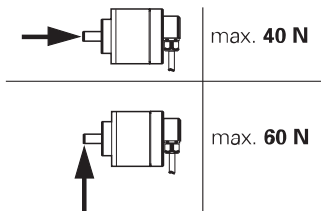

Montaaž

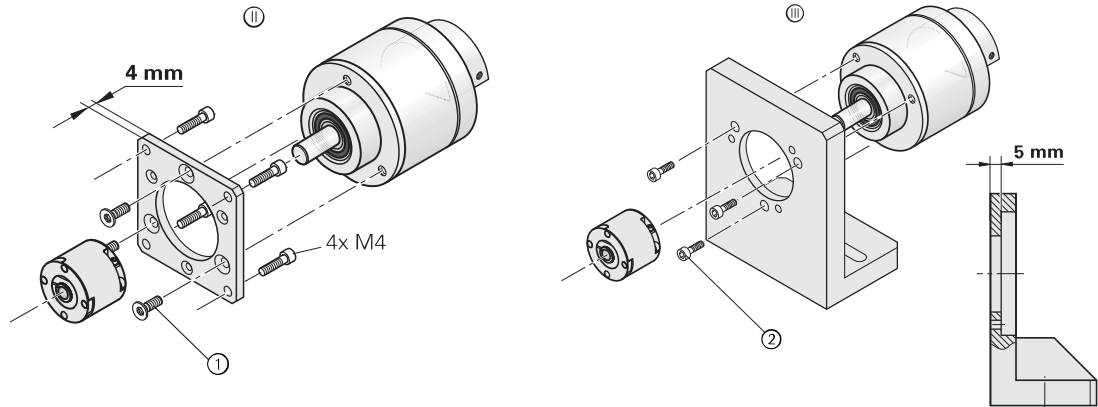

①	Nt	3x M4 ISO 14581-8.8 CHT $M_d = 2.5 \text{ Nm}$
②	Nt	3x M4 ISO 4762-A2 $M_d = 2.5 \text{ Nm}$

Paigaldusmõõtmed / Paigaldus

Paigaldusmõõtmed (mm)

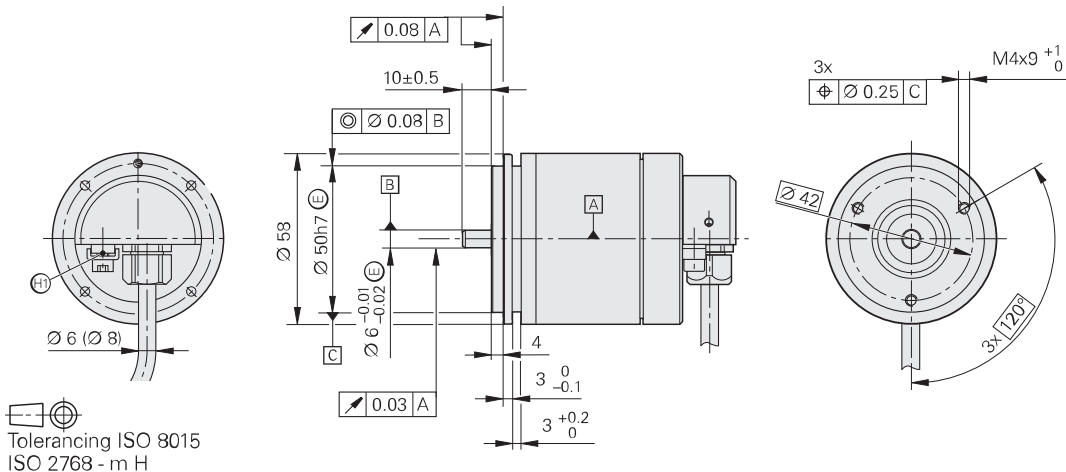

(H1) Maandus- ja potentsiaaliühtlustuse ühendusosa vastavalt DIN EN 60079-0

(A) Hoiustamine

Montaaž



Ettevaatust: Vigastusohht pöörlevate osade tõttu. Pange tähele puudutuskaitset!

Kontrollida võlli nihet

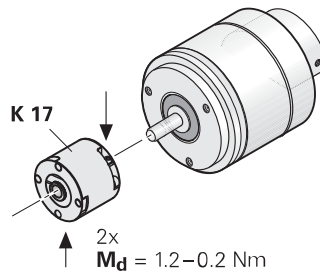
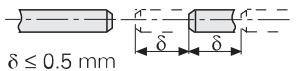
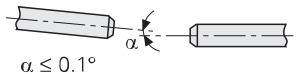
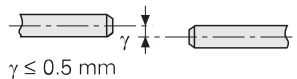

Montaaž

①, ② = Paigaldusvõimalused

Võlliotsa maksimaalne koormus

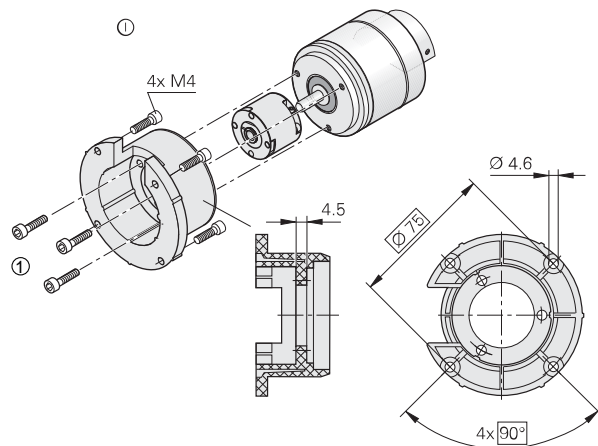
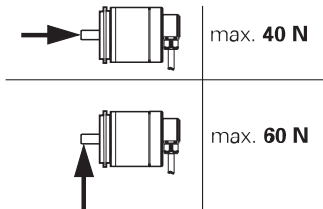

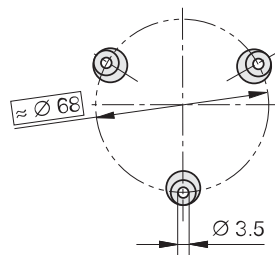
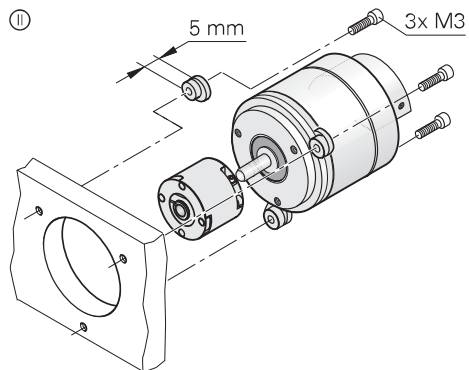

① 3x M4
ISO 4762-A2
 $M_d = 2.5 \text{ Nm}$

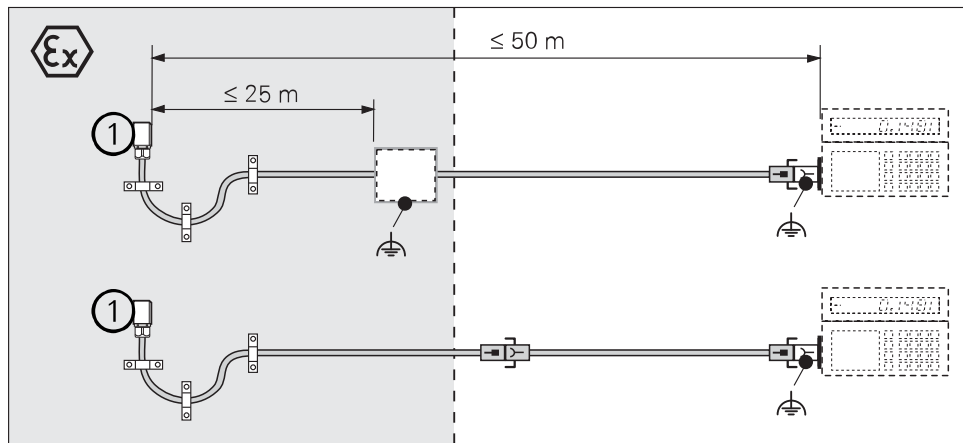

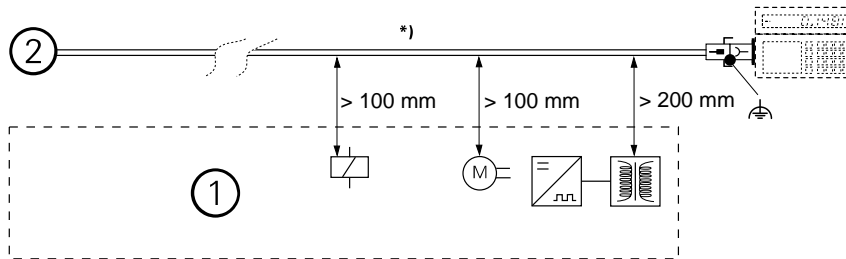

① Pöördandur

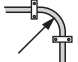

	
Ø 6 mm	R ≥ 20 mm
Ø 8 mm	R ≥ 40 mm

*)	Kinnitage kaabel tõmbetõkisega
①	Minimaalne vahekaugus häireallikatest
②	Pöördandur
R	Käänderaadius

Viikude jaotus

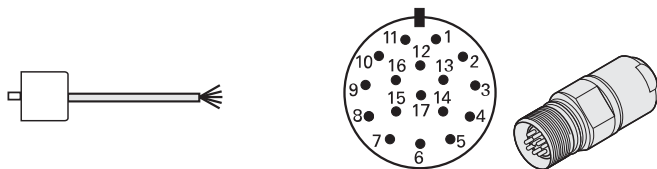

	7	1	10	4	15	16	12	13	14	17	8	9	3
	U_P	Sensor U _P	0 V	Sensor 0 V	A+	A-	B+	B-	DATA	$\overline{\text{DATA}}$	CLOCK	$\overline{\text{CLOCK}}$	$\overline{\text{U}}_{\text{aS}}$
	BNGN	BU	WHGN	WH	GNBK	YEBK	BUBK	RDBK	GY	PK	VT	YE	RD

Mittekasutatavaid tihvte või juhtmeid ei tohi ühendada!

Väliskate korpusega ühendatud

Anduri juhe on mõõteseadme sees ühendatud toitejuhtmega.

HEIDENHAIN

DR. JOHANNES HEIDENHAIN GmbH

Dr.-Johannes-Heidenhain-Straße 5

83301 Traunreut, Saksamaa

 +49 8669 31-0

 +49 8669 32-5061

E-post: info@heidenhain.de

Technical support  +49 8669 32-1000

Measuring systems  +49 8669 31-3104

E-post: service.ms-support@heidenhain.de

TNC support  +49 8669 31-3101

E-post: service.nc-support@heidenhain.de

NC programming  +49 8669 31-3103

E-post: service.nc-pgm@heidenhain.de

PLCprogramming  +49 8669 31-3102

E-post: service.plc@heidenhain.de

Lathe controls  +49 8669 31-3105

E-post: service.lathe-support@heidenhain.de

www.heidenhain.de